



CROMSON

Expertise · Quality · Innovation

HAND TOOLS

ABRASIVES

CUTTING TOOLS

MAINTENANCE

MATERIAL HANDLING

POWER TRANSMISSION

SAFETY - SANITARY

SERVICES



INDUSTRIAL SUPPLIES

cromson.com

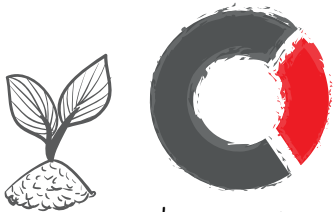

THE BEGINNING

Among them:

Angélique
20 years of experience
Cromson coordinator

Léonard
15 years of experience
Captain Cromson

Christophe
32 years of experience
Chief, Visionary leader

André
42 years of experience
Master, quiet strength

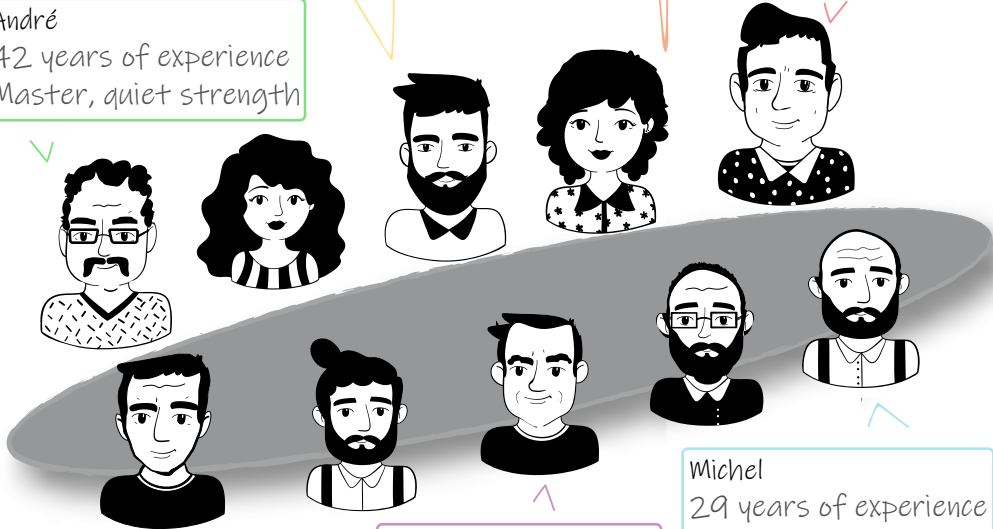

Robert
42 years of experience
Cutting Tools Pro

Marc
32 years of experience
Communications Genius

Michel
29 years of experience
Tool God

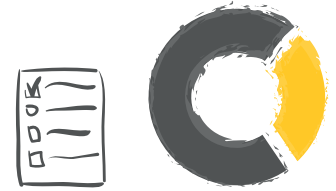

ANALYSIS



NORTH AMERICAN
MARKET RESEARCH

MEETING WITH
INTERNATIONAL
MANUFACTURERS



ATTENDING
INTERNATIONAL
TRADE SHOWS

COMPARATIVE
REAL-WORLD
TESTING



CONSULTATION WITH
KEY CUSTOMERS

MULTIPLE
ROUND TABLES



BRAINSTORMING



FAMILY VALUES
RESPECT
PASSION
EFFICIENCY
COLLABORATION



AMBITION
AND KNOW-HOW



CONSOLIDATION
OF PASSIONATE
PEOPLE



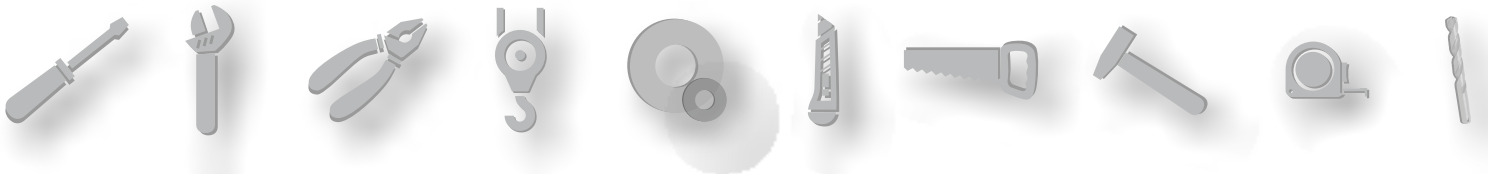

CROMSON'S STORY...

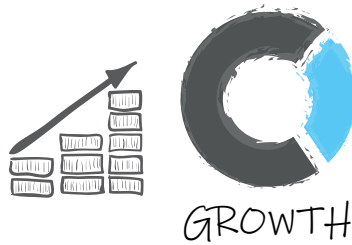
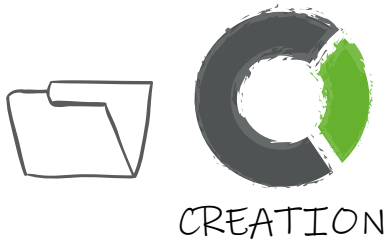

BRAND DESIGN 

 2012 BEGINNING

 ONLINE AVAILABILITY

CANADA



 2014 ANALYSIS

industrial-supplies.ca

NORTH AMERICAN AND EUROPEAN MANUFACTURING



 2016 LAUNCH TOOLS ABRASIVES

QUICK DELIVERY



MEDIAS

2018 CUTTING TOOLS MATERIAL HANDLING

AVAILABLE AT +17 COMPANIES

PRESENTATION AND CUSTOMER TESTING

2019 MADE-TO-MEASURE FOAM TOOLS 2.0 MAINTENANCE SAFETY



PARTICIPATIVE BRAND

2020 SANITARY
2021 POWER TRANSMISSION AND SERVICES

CROMSON ACTIVELY SUPPORTS LOCAL AND INTERNATIONAL GOODWILL ORGANIZATIONS



MAKE INNOVATION ACCESSIBLE

QUALITY

INNOVATION







Derived from two root words:

CHROME (Crom): 24th element of the periodic table. A metal unaltered by air and stable in the presence of water. In metallurgy, chrome assists in the formation of hard and resistant alloys.
Son (son): in direct descendance. This word refers to our business model that grows with the addition of each company, much like a family, transmitting its values of loyalty, commitment, and synergy.

Put together, **CROMSON** is the private label of industrial supplies distributed exclusively by Ficodis group companies. Much like Chrome, it offers high-quality resistant products designed for industrial applications. **CROMSON** is a socially responsible brand representing companies that have passion, collaboration and creativity, working together to make it an innovative brand focused on customer needs.





CROMSON is a socially responsible brand that wants its growth to leave a positive impact based on its values.

-  CROMSON makes quality and technically-driven choices:
 -  Partnership with industry-leading manufacturers primarily in North America and Europe.
 -  Product selection based on the client's essential needs.
 -  Available at every local distributor, closest to the customer.

Therefore, in choosing Cromson, the carbon footprint throughout its supply and distribution chain is reduced.

CROMSON actively supports local and international associations by devoting a portion of its sales profits to help support these organizations.

By using and buying CROMSON products, you are actively taking part in helping our community.

-  On an international level, CROMSON supports the EPIC Foundation. Created by philanthropist Alexandre Mars, this foundation gives 100% of the funds it collects back to associations that have been audited and evaluated.
-  Locally, CROMSON supports associations that work to encourage academic success in its communities.



Product Index

 **HAND TOOLS**

P. 6

 **ABRASIVES**

P. 48

 **CUTTING TOOLS**

P. 58

 **MAINTENANCE**

P. 70

 **MATERIAL HANDLING**

P. 82

 **POWER TRANSMISSION**

P. 90

 **SAFETY - SANITARY**

P. 104

 **SERVICES**

P. 125

 **INDEX**

P. 134



LIFETIME WARRANTY

CROMSON tools come with a lifetime warranty except for the products listed below:

- ABS and ALU storage boxes
- Storage box CR4001
- Storage case ETC14
- Select storage foam
- Non-warranty items: abrasives, maintenance, cutting tools, material handling, safety & sanitary products, chains, sprockets



CROMSON will exchange any defective products used under normal conditions and according to its intended use.

CROMSON ensures that its products are manufactured according to industry standards and that each of them is guaranteed against manufacturing defects during its lifetime*.

CONDITIONS OF APPLICATION OF THE WARRANTY

This warranty applies only to new CROMSON products purchased from a CROMSON distributor.

Products with signs of misuse, tampering, abnormal wear and tear, abnormal use, modifications or that haven't been maintained properly will be excluded from the warranty.

For a set, the warranty is the one associated with the retail products it contains.

In the case of a product that has been discontinued, CROMSON reserves the right to offer a product that is technically equivalent or superior depending on the product's development.

The warranty is limited to defective parts.

CROMSON cannot be held responsible for any damages related to its products.

TERMS OF USE FOR THE WARRANTY

Any claim made under the warranty must be accompanied by proof of purchase from the customer.

Defective products must be returned through the original distributor.

The products are appraised by our technical services who then decide how the warranty will be applied.

* Product used for the intended application.

LEGEND



ALUMINUM



STAINLESS STEEL



WOOD



STEEL



CONCRETE



Excellent grip on rusted or damaged parts
Increased surface contact
Reduced corner rounding
Contacts the fastener on the flats not on the corners



Additional Information



Precise return springs to reduce the risk of muscle injury



HAND TOOLS

ONE MOTTO AND A SINGLE GOAL:
PERFORMANCE AND EASE OF USE.



EXPERTISE

Products researched and designed for professional use that meet or exceed industry standards



QUALITY

A selection of performance-oriented materials offering the best value for the money



INNOVATION

A range combining comfort, durability and strength

1/4" TOOLS



1/4" TOOLS

1/4" Drive ratchet - 72 teeth

Chrome vanadium steel
Standards : ISO 3315

Resistant and precise ratchet for use in all types of environments

Quick and convenient one-handed rotation change using the reversing ring

Ergonomic and comfortable composite handle that ensures a solid grip

Precise, it allows working in reduced spaces thanks to its compact head and low angle of displacement

Part Number	Size	Length
CR2000	1/4"	140 mm - 5-1/4"

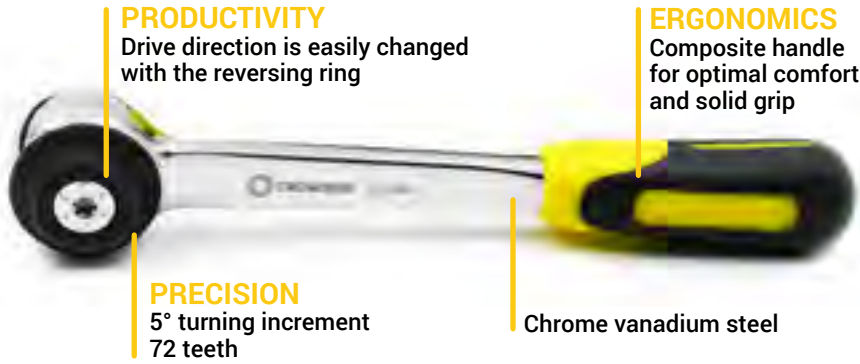

Accessories 1/4"

Chrome vanadium steel
Standards: ISO 3316-1174/1
Polished chromed finish

Product name	Part Number	Size	Length
Extension	CR2001	1/4"	100 mm - 4"
Extension	CR2002	1/4"	50 mm - 2"
Universal joint	CR2003	1/4"	38 mm - 1-1/2"



U-joint's angle allows easier access for hard to reach fasteners

6-point metric sockets, 1/4" drive

Chrome vanadium steel
Standards: ISO 691/1711 - 1/1174 - 1/2725 - 1/3315
Polished chrome finish



SO EASY profile : safer for the fastener and more powerful.



Part Number	Size	Height (H)
CR1000	4 mm	25 mm
CR1001	5 mm	25 mm
CR1002	5.5 mm	25 mm
CR1003	6 mm	25 mm
CR1004	7 mm	25 mm
CR1005	8 mm	25 mm
CR1006	9 mm	25 mm
CR1007	10 mm	25 mm
CR1008	11 mm	25 mm
CR1009	12 mm	25 mm
CR1010	13 mm	25 mm
CR1011	14 mm	25 mm

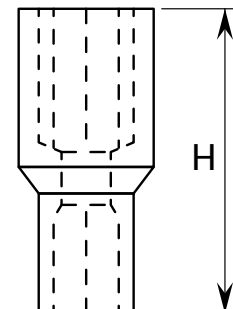

6-point SAE sockets, 1/4" drive

Chrome vanadium steel
Standards: ISO 691/1711 - 1/1174 - 1/2725 - 1/3315
Polished chrome finish



SO EASY profile : safer for the fastener and more powerful.



Part Number	Size	Height (H)
CR1500	3/16"	31/32"
CR1501	7/32"	31/32"
CR1502	1/4"	31/32"
CR1503	9/32"	31/32"
CR1504	5/16"	31/32"
CR1505	11/32"	31/32"
CR1506	3/8"	31/32"
CR1507	13/32"	31/32"
CR1508	7/16"	31/32"
CR1509	1/2"	31/32"
CR1510	9/16"	31/32"

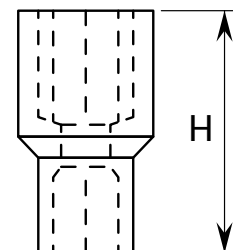

1/4" Drive bit-holder screwdriver

Chrome vanadium steel
Standards: ISO 3315 - 1174/1

Ergonomic tool with many available accessories for every job



Part Number	Length
CR4002	6"







1/4" Drive bit-holder socket

Chrome vanadium steel
Standards: ISO 1174/1 - DIN 3120

Part Number	Length
CR2004	15/16"



Set of 30 bits and bit-holder

-  Square
-  Slotted
-  Hexagonal
-  TORX®
-  Phillips®
-  Pozidriv®

Hardened steel bits
Plastic box

Standards: ISO 1173/2351 - 3/2351-3, DIN 3126/3127-1

Contents:
1 Bit holder
5 SLOTTED bits (SL): 3,5, 4,5, 5,5, 6,5, 8
9 TORX bits (T): 8, 9, 10, 15, 20, 25, 27, 30, 40
3 PHILLIPS bits (PH): 1, 2, 3
3 POZIDRIV bits (PZ): 1, 2, 3
7 HEXAGONAL bits (HEX): 2, 3, 4, 5, 6, 7, 8
3 SQUARE bits (SQ): 1, 2, 3

Storage box included
Handy belt clip for easy access

Part Number	CR4001
-------------	--------



3/8" TOOLS



EASYCLICK 3/8" Drive composite ratchet - 72 teeth

Standards: NF ISO 1174-1

Resistant and precise ratchet for use in all types of environments

72 tooth ratchet with 5° turning increments

Features a reversing lever for easy one-handed use

Composite body, 15% lighter than a classic ratchet

Scratch-resistant matte finish

Easy to use and simple maintenance

Hole in handle for easy storage



Part Number	Size	Length
CR2100	3/8"	200 mm - 8"

PRODUCTIVITY

Time saving **PRESS** System, push button quick socket release

Reverse lever with one finger

PRECISION

5° turning increment
Ideal when space is limited
72 teeth

Composite handle

ERGONOMICS

15% lighter than a classic ratchet
Scratch-resistant matte finish



Accessories 3/8"

Chrome vanadium steel
Standards: ISO 3316-1174/1
Polished chromed finish

Product name	Part Number	Size	Length
Extension	CR2103	3/8"	75 mm - 3"
Extension	CR2106	3/8"	150 mm - 6"
Universal joint	CR2105	3/8"	55 mm - 2-3/16"



U-joint's angle allows easier access for hard to reach fasteners

6-Point metric sockets, 3/8" drive

Chrome vanadium steel
Standards: ISO 1173 - ISO 1174-1
Polished chrome finish



SO EASY profile : safer for the fastener and more powerful



Part Number	Size	Height (H)
CR1034	6 mm	28 mm
CR1035	7 mm	28 mm
CR1036	8 mm	28 mm
CR1037	9 mm	28 mm
CR1038	10 mm	28 mm
CR1039	11 mm	28 mm
CR1040	12 mm	28 mm
CR1041	13 mm	28 mm
CR1042	14 mm	28 mm
CR1043	15 mm	28 mm
CR1044	16 mm	28 mm
CR1045	17 mm	30 mm
CR1046	18 mm	30 mm
CR1047	19 mm	30 mm
CR1048	20 mm	30 mm
CR1049	21 mm	30 mm
CR1050	22 mm	30 mm
CR1051	24 mm	30 mm

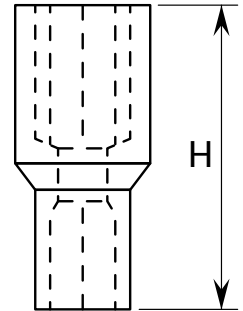

6-Point SAE sockets, 3/8" drive

Chrome vanadium steel
Standards: ISO 1173 - ISO 1174-1
Polished chrome finish



SO EASY profile : safer for the fastener and more powerful



Part Number	Size	Height (H)
CR1525	1/4"	1"
CR1526	5/16"	1"
CR1527	3/8"	1-1/4"
CR1528	7/16"	1-1/4"
CR1529	1/2"	1-1/4"
CR1530	9/16"	1-1/4"
CR1531	5/8"	1-1/4"
CR1532	11/16"	1-1/2"
CR1533	3/4"	1-1/2"

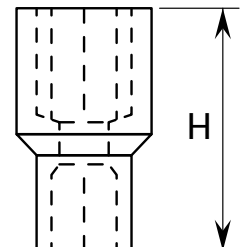

6-Point deep metric sockets, 3/8" drive

Chrome vanadium steel
Standards: ISO 3316 - ISO 1174-1
Polished chrome finish



SO EASY profile : safer for the fastener and more powerful

Part Number	Size	Height (H)
CR1615	8 mm	64 mm
CR1616	9 mm	64 mm
CR1617	10 mm	64 mm
CR1618	11 mm	64 mm
CR1619	12 mm	64 mm
CR1620	13 mm	64 mm
CR1621	14 mm	64 mm
CR1622	15 mm	64 mm
CR1623	16 mm	64 mm
CR1624	17 mm	64 mm
CR1625	18 mm	64 mm
CR1626	19 mm	64 mm
CR1627	21 mm	64 mm

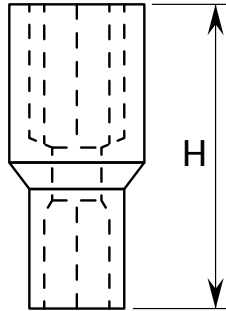

6-Point deep SAE sockets, 3/8" drive

Chrome vanadium steel
Standards: ISO 3316 - ISO 1174-1
Polished chrome finish



SO EASY profile : safer for the fastener and more powerful

Part Number	Size	Height (H)
CR1813	3/8"	2-1/2"
CR1814	7/16"	2-1/2"
CR1815	1/2"	2-1/2"
CR1816	9/16"	2-1/2"
CR1817	5/8"	2-1/2"
CR1818	11/16"	2-1/2"
CR1819	3/4"	2-1/2"
CR1820	13/16"	2-1/2"
CR1821	7/8"	2-1/2"

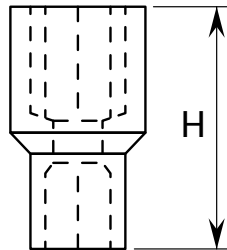

1/2" TOOLS



1/2" Drive ratchet - 72 teeth

Chrome vanadium steel
Standards : ISO 3315

Resistant and precise ratchet for use in all types of environments

Quick and convenient one-handed rotation change using the reversing ring

Ergonomic and comfortable composite handle that ensures a solid grip

Precise, it allows working in reduced spaces thanks to its compact head and low angle of displacement



Part Number	Size	Length
CR2005	1/2"	250 mm - 10"

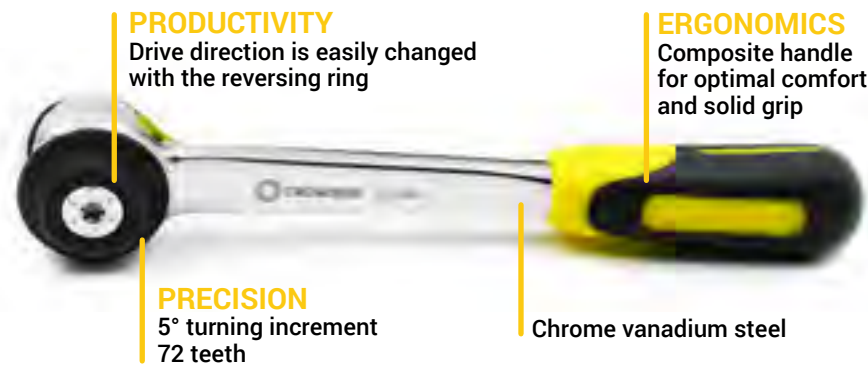

Accessories 1/2"

Chrome vanadium steel
Standards: ISO 3316-1174/1
Polished chromed finish

Product name	Part Number	Size	Length
Extension	CR2006	1/2"	250 mm - 10"
Extension	CR2007	1/2"	125 mm - 5"
Universal joint	CR2008	1/2"	72 mm - 3"



U-joint's angle allows easier access for hard to reach fasteners

6-Point metric sockets, 1/2" drive

Chrome vanadium steel
Standards: ISO 691/1711 - 1/1174 - 1/2725 - 1/3315
Polished chrome finish



SO EASY profile : safer for the fastener and more powerful



Part Number	Size	Height (H)
CR1012	10 mm	38 mm
CR1013	11 mm	38 mm
CR1014	12 mm	38 mm
CR1015	13 mm	38 mm
CR1016	14 mm	38 mm
CR1017	15 mm	38 mm
CR1018	16 mm	38 mm
CR1019	17 mm	38 mm
CR1020	18 mm	38 mm
CR1021	19 mm	38 mm
CR1022	20 mm	38 mm
CR1023	21 mm	38 mm
CR1024	22 mm	38 mm
CR1025	24 mm	38 mm
CR1026	25 mm	38 mm
CR1027	26 mm	40 mm
CR1028	27 mm	40 mm
CR1029	28 mm	40 mm
CR1030	29 mm	40 mm
CR1031	30 mm	42 mm
CR1032	31 mm	42 mm
CR1033	32 mm	42 mm

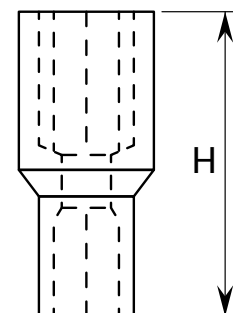

6-Point SAE sockets, 1/2" drive

Chrome vanadium steel
Standards: ISO 691/1711 - 1/1174 - 1/2725 - 1/3315
Polished chrome finish



SO EASY profile : safer for the fastener and more powerful



Part Number	Size	Height (H)
CR1511	3/8"	1-1/2"
CR1512	7/16"	1-1/2"
CR1513	1/2"	1-1/2"
CR1514	9/16"	1-1/2"
CR1515	5/8"	1-1/2"
CR1516	11/16"	1-1/2"
CR1517	3/4"	1-1/2"
CR1518	13/16"	1-1/2"
CR1519	7/8"	1-1/2"
CR1520	15/16"	1-1/2"
CR1521	1"	1-9/16"
CR1522	1-1/16"	1-21/32"
CR1523	1-1/8"	1-11/16"
CR1524	1-1/4"	1-23/32"

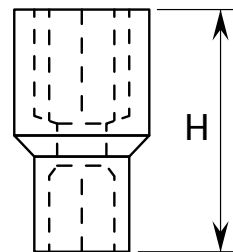

6-Point deep metric sockets, 1/2" drive

Chrome vanadium steel
Standards: ISO 3316 - ISO 1174-1
Polished chrome finish



SO EASY profile : safer for the fastener and more powerful

Part Number	Size	Height (H)
CR1600	10 mm	77 mm
CR1601	12 mm	77 mm
CR1602	13 mm	77 mm
CR1603	14 mm	77 mm
CR1604	15 mm	77 mm
CR1605	16 mm	77 mm
CR1606	17 mm	77 mm
CR1607	18 mm	77 mm
CR1608	19 mm	77 mm
CR1609	20 mm	77 mm
CR1610	21 mm	77 mm
CR1611	22 mm	77 mm
CR1612	23 mm	77 mm
CR1613	24 mm	77 mm
CR1614	27 mm	77 mm

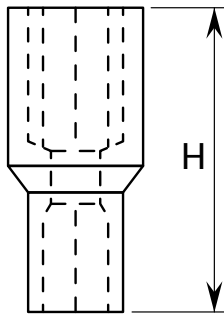

6-Point deep SAE sockets, 1/2" drive

Chrome vanadium steel
Standards: ISO 3316 - ISO 1174-1
Polished chrome finish



SO EASY profile : safer for the fastener and more powerful

Part Number	Size	Height (H)
CR1800	7/16"	3-1/32"
CR1801	1/2"	3-1/32"
CR1802	9/16"	3-1/32"
CR1803	5/8"	3-1/32"
CR1804	11/16"	3-1/32"
CR1805	3/4"	3-1/32"
CR1806	13/16"	3-1/32"
CR1807	7/8"	3-1/32"
CR1808	15/16"	3-1/32"
CR1809	1"	3-1/32"
CR1810	1-1/16"	3-1/32"
CR1811	1-1/8"	3-1/32"
CR1812	1-1/4"	3-1/32"

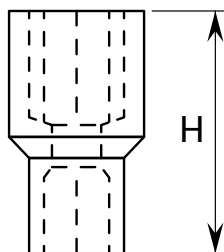



10 PC. SCREWDRIVER SET

Part Number : CR2800

- Ergonomic
- Rugged
- Multifunction perforated handle
- Chrome vanadium steel blade
- Easily identifiable
- Strong grip
- 25% more torque transfer

+ 25%





STORAGE SOLUTION

Tool organizer made from "SELECT" firm foam, included with 10-pc. set.

SLOTTED



- SL 1/4 x 4"
- SL 5/16 x 6"
- SL 3/8 x 10"
- SL 3/8 x 12"

PHILLIPS



- PH 1 x 4"
- PH 2 x 5"
- PH 3 x 6"

SQUARE

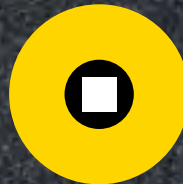

- SQ 1 x 3"
- SQ 2 x 4"
- SQ 3 x 6"



Size of the organizer foam

- Width : 18"
- Depth : 12"
- Height : 1-3/4"

Stores directly
into tool chest drawers
and roller cabinets



All our screwdrivers are equipped with an ergonomic handle and a chrome vanadium steel blade

- Effortless tightening of fasteners
- Shock resistant for durable performance
- Multifunction perforated handle
- Easily identifiable
- 25% more torque transfer

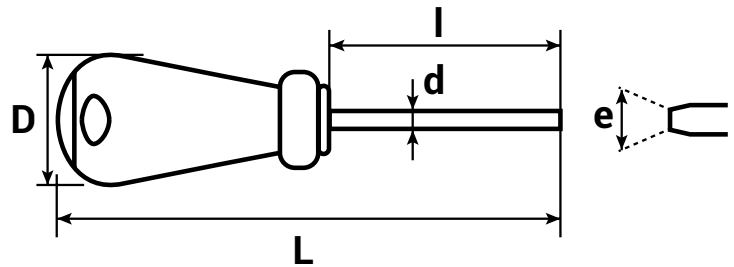

Slotted screwdrivers



Part Number	e x l (in)	l (mm)	d (mm)	D (mm)	L (mm)
CR2504	SL 1/4 x 4"	102	6	34	215
CR2506	SL 5/16 x 6"	152	8	38	277
CR2510	SL 3/8 x 10"	250	10	38	375
CR2512	SL 3/8 x 12"	300	10	38	425

Phillips screwdrivers



Part Number	e x l (in)	l (mm)	d (mm)	D (mm)	L (mm)
CR2603	PH 1 x 3"	76	5	32	179
CR2604	PH 2 x 4"	102	6	34	215
CR2606	PH 3 x 6"	152	8	34	215

Square screwdrivers



Part Number	e x l (in)	l (mm)	d (mm)	D (mm)	L (mm)
CR2704	SQ 1 x 4"	102	5	32	227
CR2705	SQ 2 x 5"	127	6	34	240
CR2706	SQ 3 x 6"	152	8	38	278



CROMSON Super 8 Plus Screwdriver PICQUIC

Plus: Removable and reversible stainless steel shaft to be used as 1/4" or 5/16" nut driver

Comes with 7 hex bits and two nut drivers

3" long bits precision machined and hardened to withstand years of use

Hexagon alloy handle that adapts to a 7/16" wrench to help loosen stubborn screws

Powerful magnet to hold bits in the handle

Solid handle for maximum comfort and torque

Meets all needs

Part Number : CR2900



- Performance
- Durability
- Power



12-Point metric combination wrenches



Chrome vanadium steel

SO EASY profile : rugged and safer for the fastener



Part Number	Size
CR3000	9 mm
CR3001	10 mm
CR3002	11 mm
CR3003	12 mm
CR3004	13 mm
CR3005	14 mm
CR3006	15 mm
CR3007	16 mm
CR3008	17 mm
CR3009	18 mm
CR3010	19 mm
CR3012	21 mm
CR3013	22 mm
CR3015	24 mm

12-Point SAE combination wrenches



Chrome vanadium steel

SO EASY profile : rugged and safer for the fastener



Part Number	Size
CR3500	3/8"
CR3501	7/16"
CR3502	1/2"
CR3503	9/16"
CR3504	5/8"
CR3505	11/16"
CR3506	3/4"
CR3507	13/16"
CR3508	7/8"
CR3509	15/16"
CR3510	1"
CR3511	1-1/16"
CR3512	1-1/8"
CR3513	1-1/4"

Storage pouch for 14 combination wrenches

Long-lasting and waterproof

14 storage locations with tie-string to store and organize your tools

Eyelets for easy wall hanging

Easy to carry and clean

Part Number ETC14



i BUILD YOUR OWN SET WITH OUR WRENCHES ON PAGE 24



Customizable kits - coming soon



Chrome adjustable wrenches

Chrome vanadium steel
Standards: ISO 6787

Large ridged knurl for easier adjustment
Measurement scale on wrench



Part Number	Size
CR3023	6" - 150 mm
CR3024	8" - 200 mm
CR3025	10" - 250 mm
CR3026	12" - 300 mm
CR3027	15" - 375 mm
CR3028	18" - 450 mm

Set of 9 ball end hex keys

Chrome vanadium steel
Standards : ISO 2936

Ball end hex to access fasteners up to an angle of 30°



Part Number	metric SAE
CR4000 mm	1.5, 2, 2.5, 3, 4, 5, 6, 8, 10 mm
CR4500 in	1/16, 5/64, 3/32, 1/8, 5/32, 5/16, 1/4, 5/64, 3/8"

Quality Performance Consistency
Durability Resistance Precision
Rugged Quality Performance
Consistency Durability Resistance
Precision Rugged Quality
Performance Consistency Durability
CLAMPING TOOLS



Quality Durability Resistance
Precision Rugged Consistency
Performance Durability Resistance
Quality Precision Rugged
Consistency Performance



Pipe holder



Anvil

Forged steel vise with swivel-base

High tensile forged steel body with a machined anvil

Precision glide for effortless operation

Replaceable inserted jaws made of case-hardened chromium molybdenum steel

Professional quality for perfect stability

Supplied with 360° swivel base (removable for rigid base mounting)

Pipe holder

Part Number	Jaw size	Opening (in)
EA5125	125 mm - 5"	6-5/16"
EA6150	150 mm - 6"	7-15/32"

- High quality
- Long-lasting
- Resistant
- Rugged



Removable magnetic jaw sets with prismatic surface

Aluminum

4 V-grooves for vertical (3) and horizontal (1) clamping of round parts

Upper rests to hold thin pieces

Magnetic mounting

Universal, fits on all 5" and 6" vises

Part Number	Jaw size
EA8125	125 mm - 5"
EA8150	150 mm - 6"



Quick-clamping woodworkers vise

Large clamping area

Clamping screws and chrome guides

Pre-drilled holes for mounting protective wooden jaws

The retractable stop with use of a bench hold-down increases clamping capacity

Trigger action releases the screw permitting quick opening or closing of the vise

Part Number	Length	Opening (in)
EA7225	225 mm - 8-7/8"	13-3/8"



Woodworkers vise

Large clamping area (150 x 40 mm)

Ideal for woodworking

Built-in plastic jaws incorporated to avoid marking parts

Part Number	Length	Opening (in)
EA7155	155 mm - 6-3/32"	5-15/16"



Multi-use folding table

■ Portable

■ Sturdy

■ High stability

Wooden table top

Lateral steel corner protectors

45 mm diameter tube feet

Quick and easy assembly and disassembly

Part Number CR7230

Length	Width	Height	Weight (lb)
1100 mm	600 mm	820 mm	55
43-5/16"	23-5/8"	32-9/32"	



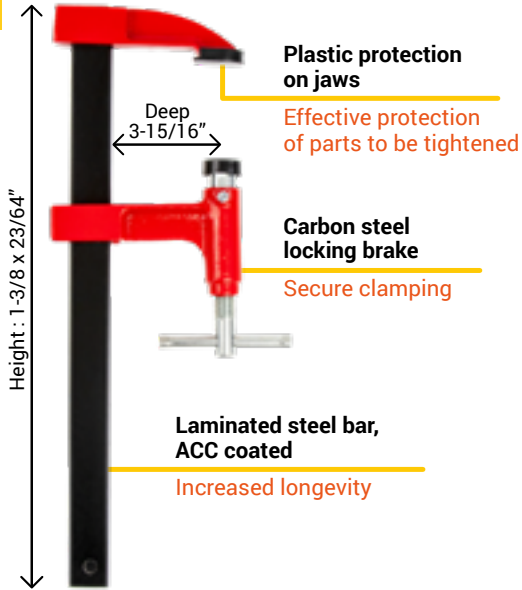

One-handed clamps



Clamping power up to 10 000 N



Epoxy coated high-resistant spheroidal graphite cast iron jaws

One-handed system to leverage force for maximum effortless clamping

Part Number	Opening (in)	Weight (lb)
CR4650	19-11/16"	5
CR4651	23-5/8"	6
CR4652	31-1/2"	7
CR4653	39-3/8"	8
CR4654	47-1/4"	9

Quick support rods

Keeps various items in place such as ventilation ducts, ceiling moldings, bath contours, etc.

Sliding expandable sleeve

Final adjustment by screws

Secure locking

Non-slip rubber glide pads

- **Maintain**
- **Strength**
- **Lock**



Part number	Opening min.		Weight Capacity Kg	Opening max .		Weight Capacity Kg
	cm	in		cm	in	
CR4600	65	2'1"	200	115	3'9"	130
CR4601	101	3'3"	200	177	5'9"	120
CR4602	160	5'3"	200	290	9'6"	50
CR4603	210	6'10"	200	390	12'19"	40

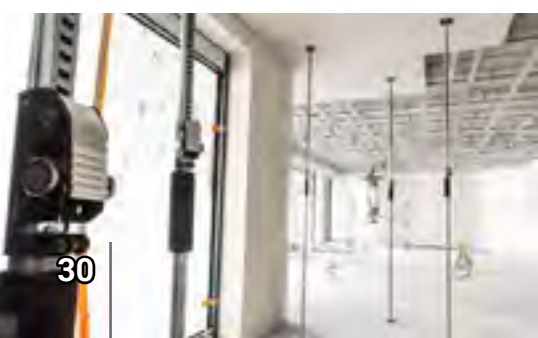

Ball pein hammer with hickory handle

Standards: ISO 15601

Rugged and resistant hickory handle

Hardened steel carbon XC head

Metal wedges to maintain head on handle

Shape of the handle allows for a better grip



Part Number	Length	Top Weight
CR4005	12-5/8"	12 oz

Ball pein hammers with fiberglass handle

Intensive use

High-strength and durable fiberglass handle

Fully tempered forged steel head ideal for professional use

Elongated collar provides protection against missed hits

New and improved rubber grip prevents slippage and increases shock absorption

Weight distribution of the hammer for more efficiency: maximizing the force of the blow and reducing fatigue

- **Less effort required**
- **Rugged**
- **High performance**

Part Number	Length	Top Weight
CR4024	13-1/2"	24 oz
CR4032	13-25/32"	32 oz



CHOOSE YOUR PLIERS ...

Anti-fatigue pliers

Return springs reduce the risk of muscle problems and fatigue



Spring-loaded diagonal cutting pliers with composite handle PRECI-R



Lineman's pliers with composite handle UNIV-R

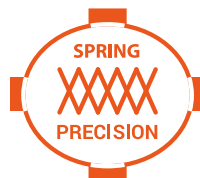

- Less effort
- Lightweight
- Precision

Return spring



A high percentage of workers are affected by a work-related disorder (WMSDs), which represents **7.3% of all causes of absenteeism** in the workplace.

Solution

The pliers' integrated return spring is designed to reduce the risk of the user developing WMSDs. The spring in the composite shafts add more comfort. The ergonomics of the composite handle is designed with an anti-slippage safety spud grip for better comfort during use.

Cuts all materials



● Diagonal Cutting pliers with composite handle

- Long-lasting
- Rugged

Tighten and cut



● Lineman's pliers with composite handle

- Heavy-duty
- Serrated nose

Access confined spaces and handle small pieces



● Composite Long Nose pliers

- Durable
- Precision

Tighten small and large pieces



● Groove joint pliers with composite handle

- Versatile
- Rugged

ANTI-FATIGUE PLIERS



Spring-loaded diagonal cutting pliers with composite handle PRECI-R

Chrome vanadium steel
Standards: ISO 5749

High frequency surface treatment for improved performance

The return spring hidden in the clamp head limits repetitive movements.

Part Number	Length
CR4003	6-1/2"

- **Less effort**
- **Lightweight**
- **Precision**



Our pliers with return spring reduce risk of injury and provide more comfort with the composite handle.

Lineman's pliers with composite handle UNIV-R

Chrome vanadium steel
Standards: ISO 5749

Built-in spring for better flexibility

Increased clamping force with serrated jaws and wire cutting function

Part Number	Length
CR4006	6-1/2"



Groove joint pliers with composite handle

Chrome vanadium steel
Standards: ISO 8976

Easier reach in limited spaces
Convenient/handy ergonomic composite handle

Large opening capacity: 2-5/16" - 8 positions

Part Number	Length
CR4004	9-7/8"

- **Strength**
- **Precision**
- **Rugged**





All of our pliers are equipped with a composite handle for unmatched grip and comfort.

Diagonal cutting pliers with composite handle

Hardened carbon steel
Polished finish

Cuts all materials

Part Number	Length
CR4100	7-1/2"

■ Long-lasting

■ Rugged



Lineman's pliers with composite handle

Hardened carbon steel
Polished finish

Tightening and cutting

Part Number	Length
CR4101	8"

■ Heavy-duty

■ Serrated nose



Additional tightening space

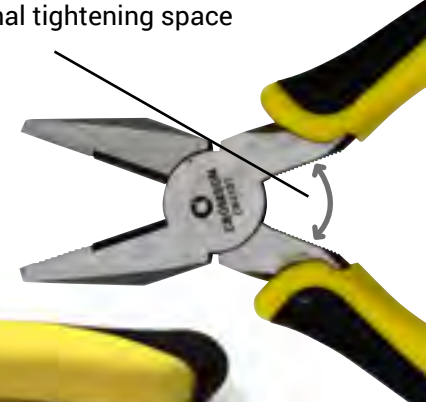

Composite long-nose pliers

Hardened carbon steel
Polished finish

Tightening for small pieces and confined spaces

Part Number	Length
CR4102	7-1/2"

■ Durable

■ Precise



LOCKING PLIERS

PERFORMANCE IN 4 FEATURES





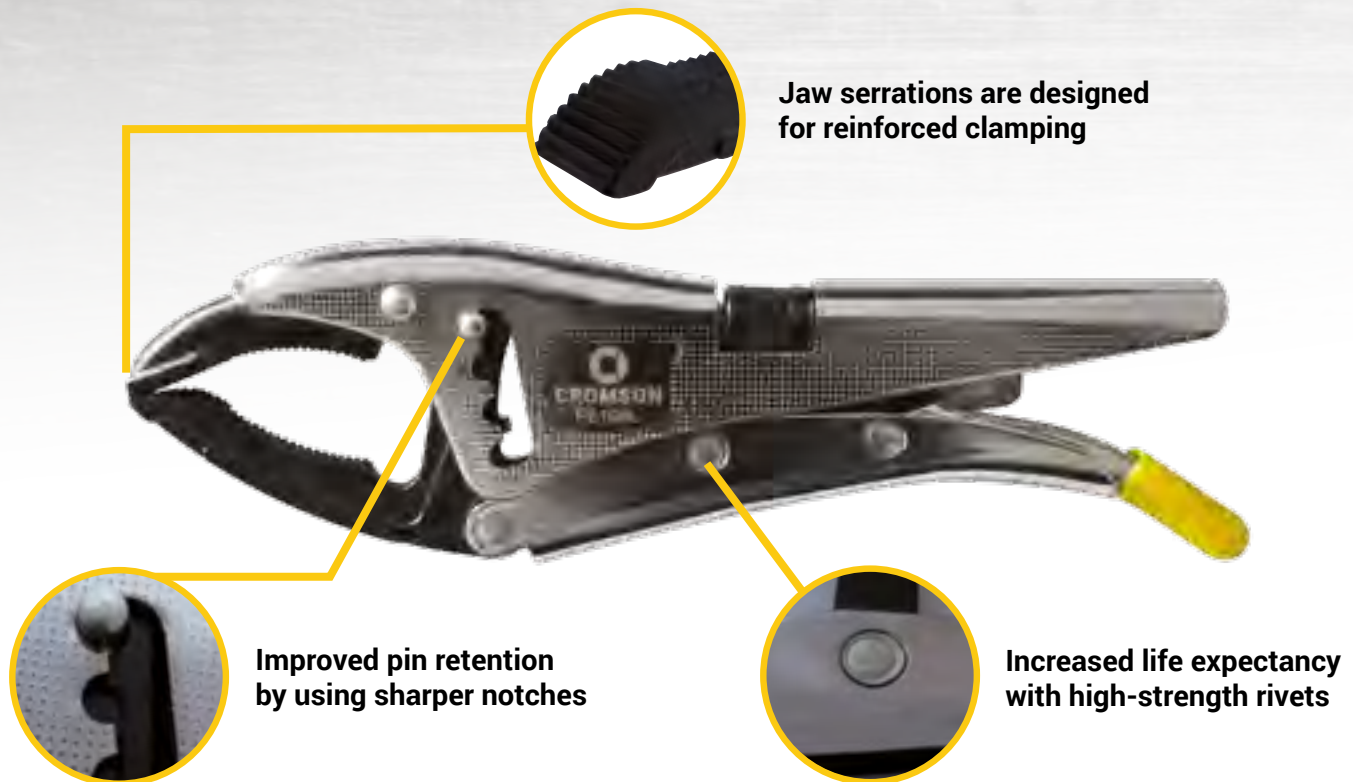

PERFORM R



Jaw serrations are designed for reinforced clamping

Improved pin retention by using sharper notches

Increased life expectancy with high-strength rivets

-  **Protection of the jaws from cataphoresis**, resistance to saline mist
Forged steel jaws, grooved and hardened with serrations at 58/60 HRC; 16 mm wide.
-  **Chromium plating protection of the body**, thicker casing and handle.
-  **Only one hand needed for clamping and unlocking** ergonomic grip
Precise and powerful tightening (300 to 600 daN) with consistently parallel jaws.
-  **Large opening** with knurled wheel for clamping force adjustment.



Application: Metal / Sheet Metal / Locksmith

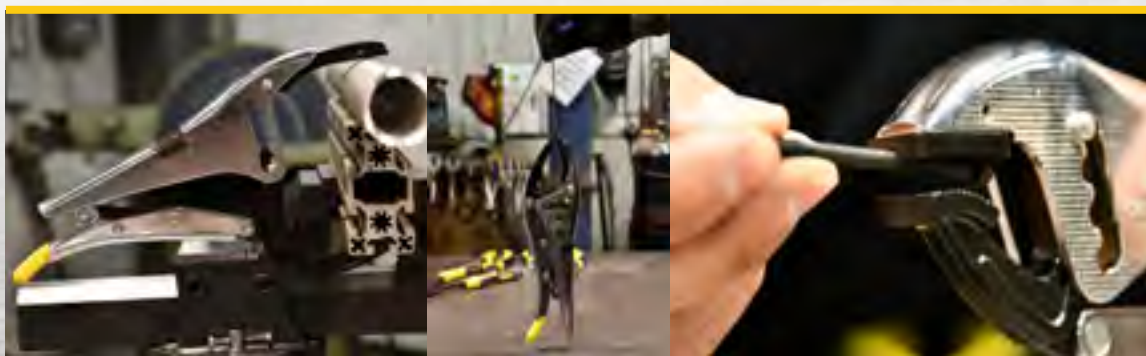

**Large capacity locking pliers, long jaws
4 setting positions - PERFORM-R1**

Part Number PE10BL

Length	Opening	Jaws depth
250 mm	80 mm	73 mm
10 in	3-1/8 in	2-7/8 in

The shape of the jaws allows many tightening possibilities.



**Large capacity locking pliers, short jaws
4 setting positions - PERFORM-R2**

Part Number PE9BC

Length	Opening	Jaws depth
220 mm	55 mm	44 mm
9 in	2-1/8 in	1-3/4 in

Flat upper jaws allow a larger tightening surface as well as increasing torque.

V-shaped upper jaw for tightening of round objects.



**Large capacity locking pliers, deep jaws
6 setting positions - PERFORM-R3**

Part Number PE11BXL

Length	Opening	Jaws depth
270 mm	130 mm	90 mm
11 in	5-1/8 in	3-1/2 in

Large tightening capacity with greater opening and clearance.

6 setting positions for easy adjustment and tightening precision.



Locking C-clamp pliers

Chrome vanadium jaws

Large opening ideal for bodywork, assembly, welding and sheet metal work

Part Number PE12GC

Length	Jaw depth	Opening	Max. tightening
280 mm	62 mm	90 mm	250 daN
11-1/32"	2-7/16"	3-9/16"	



Curved jaw locking pliers

Chrome vanadium jaws

Multi-purpose locking pliers ideal for holding round workpieces.

Part Number PE13MC

Length	Jaw depth	Opening	Max. tightening
250 mm	32 mm	55 mm	530 daN
9-27/32"	1-17/64"	2-11/64"	



Locking clamp pliers with single adjusting screw

RUGGED CONSTRUCTION

The auto-tightening system with the integrated screw brake offers longer service life and saves time, while providing anti-spatter protection.

Copper trapezoidal screw reduces adjustment time and provides anti-spatter protection.

Large opening with one-hand clamping adjustment.

SECURITY

Pressed rivets, reduces the risk of snagging gloves or clothing.

ERGONOMIC

15° self-levelling copper support pad provides superior clamping surface adherence .

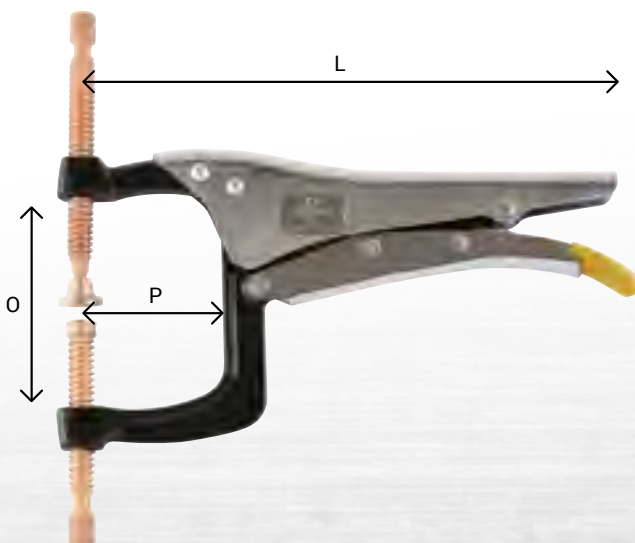

Protection of forged steel jaws against corrosion from cataphoresis.

Chrome-plated body for added protection and durability.

Part Number	Number of screws	Length (L)	Jaw depth (P)	Opening (O)	Weight (lb)
PSJ100	1	233 mm - 9"	43 mm - 1-11/16"	51 mm - 2-1/64"	1.7
PSJ101	1	252 mm - 10"	63 mm - 2-31/64"	81 mm - 3-3/16"	1.9
PSJ102	1	332 mm - 13"	143 mm - 5-5/8"	108 mm - 4-1/4"	2.7
PSJ200	2	252 mm - 10"	63 mm - 2-31/64"	75 mm - 2-61/64"	2.1

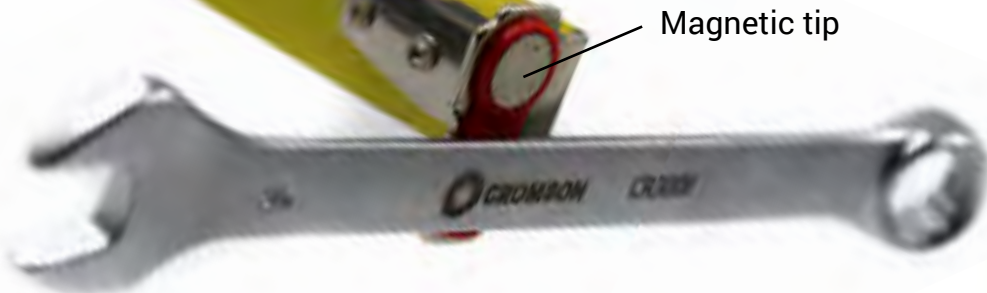

Magnetic tip measuring tapes

Ergonomic non-slip molded grip

Fully shock and abrasion resistant with nylon coated jaws

Metric and SAE readings

Belt clip

2 magnetic tips for one-handed operation

Blade brake allows better control when retracting



Part Number	Size
RM534	5 m - 16'
RM81	8 m - 26'

19 mm
3/4"

25 mm
1"

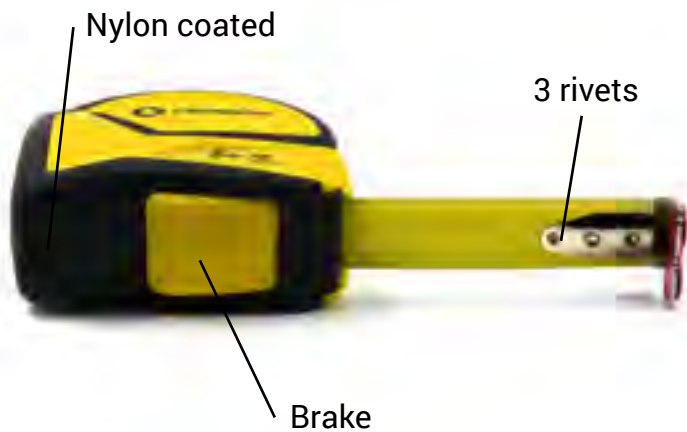



OUR STORAGE SOLUTIONS

ONE MOTTO AND A SINGLE GOAL :
CREATE CUSTOM STORAGE SOLUTIONS FOR YOUR NEEDS



EXPERTISE

Trade specialists to help you with your projects



QUALITY

A service dedicated to custom manufacturing
using only the best available materials



INNOVATION

Rethink your storage, custom solutions tailored
to your needs



BEFORE

AFTER



CUSTOM-CUT FOAM STORAGE

*** FREE WITH THE PURCHASE OF CROMSON TOOLS**

- + SPACE**
CHOOSE A SET WITH ITS PREDEFINED STORAGE OR THE OPTION OF TAILOR-MADE! WALL DISPLAY AVAILABLE.
- + TIME**
FIND YOUR TOOLS QUICKLY.
- + MONEY**
ORGANIZED - YOU WON'T FORGET A SINGLE TOOL ON THE JOB.
- + DURABILITY**
EACH TOOL IS SURROUNDED BY FOAM FOR SECURE PROTECTION.



“SELECT” FOAM
EASY TO PERSONALIZE,
THE PRECUT FOAM OFFERS A FULLY CUSTOMIZABLE SOLUTION FOR ALL YOUR
TOOL STORAGE.



AXIOM AR8-PRO+
USED TO CUT FOAM

COMPATIBLE WITH THE PACKOUT



CROM-BOX SOLUTIONS

Contact your distributor to create your custom storage solution with your existing tools or accessories

ABS Storage box - CR5000



- Ergonomic
- Stackable
- Solid
- Waterproof
- Portable

ALU Storage box - CR5001



- Compact
- Light
- Convenient
- Portable

See our tool sets designed with your needs in mind, on page 44 to 47



Create your set with our flexible foam

"SELECT" Foam

Part Number	Thickness
CR96837	1-1/8"
CR96838	2-1/4"

Two available mounting positions:

Vertical : wall display

Horizontal : drawers, CROM-BOX, tray

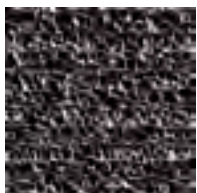

Quality foam made of several 1/8" thick layers allowing for precise cutting to fit individual tools

44 Piece metric tool set - CROM-BOX 44M

- 11 6-point sockets, 1/4" drive: 4, 5, 5.5, 6, 7, 8, 9, 10, 11, 12, 13 mm
- 12 6-point sockets, 1/2" drive: 10, 11, 12, 13, 15, 17, 18, 20, 21, 22, 24, 25 mm
- 2 ratchets: 1/4" and 1/2" drive
- 2 extensions, 1/4" drive: 50 and 100 mm
- 2 extensions, 1/2" drive: 125 and 250 mm
- 2 universal joints: 1/4" and 1/2" drive
- 11 12-point combination wrenches: 9, 10, 11, 12, 13, 15, 17, 18, 21, 22, 24 mm
- 1 set of 9 ball end hex keys (metric)
- 1 ABS storage box - 18 litres and PREMIUM high density foam included

Part Number CR6000

42 Piece SAE tool set - CROM-BOX 42I

- 10 6-point sockets, 1/4" drive: 3/16, 7/32, 1/4, 9/32, 5/16, 11/32, 3/8, 13/32, 7/16, 1/2"
- 12 6-point sockets, 1/2" drive: 3/8, 7/16, 1/2, 9/16, 5/8, 11/16, 3/4, 13/16, 7/8, 15/16, 1, 1-1/16"
- 2 ratchets: 1/4" and 1/2" drive
- 2 extensions, 1/4" drive: 2" and 4"
- 2 extensions, 1/2" drive: 5" and 10"
- 2 universal joints: 1/4" and 1/2" drive
- 10 12-point combination wrenches: 3/8, 7/16, 1/2, 9/16, 5/8, 11/16, 3/4, 7/8, 15/16, 1"
- 1 set of 9 ball end hex keys (SAE)
- 1 ABS storage box - 18 litres and PREMIUM high density foam included

Part Number CR6500



Discover our hand trucks page 87
to effortlessly transport your tool sets



10 Piece tool set - CROM-BOX 100

- 1 bit holder socket, 1/4" drive
- 1 adjustable wrench 8"
- 1 set of 30 bits and bit holder
- 1 bit holder screwdriver, 1/4" drive
- 1 composite spring-loaded cutting pliers PRECI-R
- 1 composite lineman pliers UNIV-R
- 1 composite groove joint pliers
- 1 ball pein hammer - 12 oz
- 1 magnetic tip measuring tape 5 m - 16'
- 1 ABS storage box - 18 litres and PREMIUM high density foam included



Part Number CR6600

ABS Storage box - without tools

ABS (Acrylonitrile butadiene styrene)
Standards: ISO 5749

Top and side handles

Stackable waterproof case

**Box will support a 220 lb load
and has a 55 lbs capacity**

Part Number CR5000

Capacity	Length	Width	Height	Weight (lb)
18 litres	17.6"	14.1"	4.6"	4.4



Stackable cases



48 Piece metric tool set - ALU-M

- 11 6-point sockets, 1/4" drive: 4, 5, 5.5, 6, 7, 8, 9, 10, 11, 12, 13 mm
- 15 6-point sockets, 1/2" drive: 10, 11, 12, 13, 14, 15, 16, 17, 18, 19, 20, 21, 22, 24, 25 mm
- 2 ratchets: 1/4" and 1/2" drive
- 2 extensions, 1/4" drive: 50 and 100 mm
- 2 extensions, 1/2" drive: 125 and 250 mm
- 2 universal joints: 1/4" and 1/2" drive
- 1 bit holder socket, 1/4" drive
- 9 12-point combination wrenches: 9, 10, 12, 13, 14, 15, 17, 18, 19 mm
- 1 set of 30 bits and bit holder
- 1 bit holder screwdriver, 1/4" drive
- 1 groove joint plier with composite handle
- 1 ALU storage box - 7.4 litres and PREMIUM high density foam included

Part Number CR6001

44 Piece SAE tool set - ALU-I

- 10 6-point sockets, 1/4" drive: 3/16, 7/32, 1/4, 9/32, 5/16, 11/32, 3/8, 13/32, 7/16, 1/2"
- 12 6-point sockets, 1/2" drive: 3/8, 7/16, 1/2, 9/16, 5/8, 11/16, 3/4, 13/16, 7/8, 15/16, 1, 1-1/16"
- 2 ratchets: 1/4" and 1/2" drive
- 2 extensions, 1/4" drive: 2" and 4"
- 2 extensions, 1/2" drive: 5" and 10"
- 2 universal joints: 1/4" and 1/2" drive
- 1 bit holder socket, 1/4" drive
- 9 12-point combination wrenches: 3/8, 7/16, 1/2, 9/16, 5/8, 11/16, 3/4, 15/16, 1"
- 1 set of 30 bits and bit holder
- 1 bit holder screwdriver, 1/4" drive
- 1 groove joint plier with composite handle
- 1 ALU storage box - 7.4 litres and PREMIUM high density foam included

Part Number CR6501

27 Piece metric/SAE tool set, 1/2" drive - ALU SELECT

- 12 6-point sockets, 1/2" drive: 10, 11, 12, 13, 14, 15, 16, 17, 18, 19, 20, 21 mm
- 11 6-point sockets, 1/2" drive: 3/8, 7/16, 1/2, 9/16, 5/8, 1/16, 3/4, 13/16, 7/8, 15/16, 1"
- 1 ratchet: 1/2" drive
- 2 extensions, 1/2" drive: 125 and 250 mm / 5" and 10"
- 1 universal joint: 1/2" drive
- 1 ALU storage box - 7.4 litres and SELECT foam included

Part Number CR6201



ALU Storage box - without tools

Aluminum

Compact and lightweight for easy transport

Convenient for storing tools of all sizes

Built-in elastic straps for optimized storage

Metal clasps

Reinforced corners

Part Number CR5001

Capacity	Length	Width	Height	Weight (lb)
7.4 litres	18.8"	8.5"	3"	2.8



PROFITABILITY WARRANTY

CROMSON's profitability warranty certifies that our products are designed to save you time, to be more durable and to perform as specified.

CROMSON designs, selects and markets quality products for professional use. Products in this category deteriorate or become damaged due to normal wear and tear, so they are not exchangeable. This includes tools for cutting or removing material (resharpenable tools, drill bits, saw blades or knife blades), abrasive tools (grinding wheels, sanding discs, deburring discs or cutting discs).



SAFETY GUIDE

This information is provided for the convenience of abrasive disc users. Carefully read the instructions provided with the tools before using them.

Risks related to the use of abrasive discs:

- Poor selection of type of grinding wheel
- Incorrect mounting
- Excessive speed
- Inappropriate safety shield
- Dust

Prevent serious accidents by taking simple precautions:

DO'S	DON'TS
<ul style="list-style-type: none"> • Handle and store abrasive discs with care • Inspect discs before mounting to ensure they are not damaged • Check that the grinding wheel arbour hole fits the machine shaft correctly • Use the mounting blotters that come with the grinding wheels • Ensure the correct setting of the workpiece • Use the grinding wheel guard provided on the machine • Let the new discs spin for a minute before starting • Wear eye safety goggles and extra face and hand protection if required • Turn off the power before removing the disc 	<ul style="list-style-type: none"> • Use wheels that have fallen or been damaged • Use excessive pressure when mounting the wheel between the flanges • Exceed the established rotation speed • Use dirty, flat or smooth mounting flanges • Gently tighten the mounting nut • Use a disc for a different application than intended • Start the machine before attaching the guard • Stand in front of a disc while the machine is running

LEGEND AND SECURITY ICONS

These warning icons appear on our products and packaging. They are intended to draw your attention to the safety measures to be put in place when using the products.



Wear safety gloves



Wear a respiratory mask



Refer to the operator's manual and safety guide



Do not use on angle



ALUMINUM



STEEL



STAINLESS STEEL



CONCRETE



WOOD



ABRASIVES

ONE MOTTO AND A SINGLE GOAL:
TO PROMOTE AND ENSURE THE CONTINUITY OF A JOB WELL DONE



EXPERTISE

Products researched and designed for professional use that meet or exceed industry standards



QUALITY

An expert choice of the best materials for maximum performance



INNOVATION

Smart pictograms assure simplified identification of products. Ease of handling because of innovative packaging



CROMSON IDENTIFICATION

Product Name: ALPHA CUT 01

Type of product: Meule à tronçonner Cutting Wheel

Materials:

- S** STEEL
- SS** STAINLESS STEEL
- AL** Aluminum

Part Number: MT150045

Size: 5 x .045 x 7/8

Maximum speed: RPM (revolution per minute) Max rpm - 12225

Safety standards:

- Wear safety gloves
- Wear a respiratory mask
- Refer to the operator's manual and safety guide
- Do not use on angle

More information: Visit the Cromson website for complete information

Ideal for use with:

- 90°
- 30°
- 90°
- 0-15°
- 0-15°
- 90°
- 0-15°



ALPHA TRIM Type 27 grinding wheels **A** **IN**

Aluminum oxide
Standards: ANSI B7.1



Grinding applications on carbon steel and/or stainless steel
Coarse stock removal, smoothing welds and beveling
Not recommended for soft materials
High stock removal rate, long lasting with superior performance

Part Number	Size	Max rpm	Packaging
MR274514	4-1/2 x 1/4 x 7/8"	13580	x 25
MR275014	5 x 1/4 x 7/8"	12225	x 25

ALPHA CUT 01 Type 1 cutting wheels



Aluminum oxide
Standards: ANSI B7.1
Cuts steel, stainless steel, sheet metal, pipe or structural steel
Reinforced with fiberglass



Quick, straight and precise cutting at a competitive price

Part Number	Size	Max rpm	Packaging
MT145045	4-1/2 x .045 x 7/8"	13580	x 25
MT150045	5 x .045 x 7/8"	12225	x 25



Special packaging for better handling and increased visibility

ALPHA CUT 27 Type 27 cutting wheels



Aluminum oxide
Standards: ANSI B7.1
Cuts steel, stainless steel, sheet metal, pipe or structural steel
Reinforced with fiberglass



Quick, straight and precise cutting at a competitive price

Flush cutting capability

Part Number	Size	Max rpm	Packaging
MT274545	4-1/2 x .045 x 7/8"	13580	x 25
MT275045	5 x .045 x 7/8"	12225	x 25



Wear eye protection with ANSI B7.7 and safety glasses.
465 Saint-Jean, #1001 Montréal
cromson.ca

DELTA FLEX



DELTA FLEX type 27 flap discs

S SS AL



Aluminum oxide and zirconium
Standards: ANSI B7.1

Superior performance and durability
Quiet, less dust and lower vibration levels
Trimable backing

i **2 steps in one :**
Grinding and polishing with an excellent quality finish

Different grits available

Part Number	Size	Max rpm	Grit	Packaging
DL451040	4-1/2 x 5/8-11"	13300	40	x 10
DL451060	4-1/2 x 5/8-11"	13300	60	x 10
DL451080	4-1/2 x 5/8-11"	13300	80	x 10
DL501040	5 x 5/8-11"	12000	40	x 10
DL501060	5 x 5/8-11"	12000	60	x 10
DL501080	5 x 5/8-11"	12000	80	x 10

DELTA FLEX II type 27 flap discs

A IN AL



Aluminum oxide, zirconium and ceramic
Standards : ANSI B7.1

Thanks to the ceramic grain added to the product design

Resurfacing and finishing of carbon and stainless steel and other non-ferrous metals.

Once the flaps on the disc are worn, trim its diameter to restore its appearance and initial effectiveness.

Various grains offered

Part Number	Size	Max rpm	Grit	Packaging
DL452040	4-1/2 x 7/8"	13300	40	x 10
DL452060	4-1/2 x 7/8"	13300	60	x 10
DL452080	4-1/2 x 7/8"	13300	80	x 10
DL502040	5 x 7/8"	12000	40	x 10
DL502060	5 x 7/8"	12000	60	x 10
DL502080	5 x 7/8"	12000	80	x 10

NEW PRODUCT
- C -
CREATED FOR YOU

WITH MORE STRENGTH AND LONGEVITY



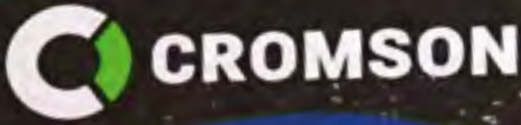

DELTA CARB Type 27 stripping discs



Silicon carbide
Standards: ANSI B7.1



Superior performance and durability

Clean and polish corrosion, rust, paint, glue, varnish, calcium and lime deposits on all surfaces.

Open structure prevents buildup

For all materials

Part Number	Size	Max rpm	Packaging
MD455811	4-1/2 x 5/8-11"	12000	x 10
MD505811	5 x 5/8-11"	11000	x 10



Type 1 bench grinding wheels 6x1x1

Brown aluminum oxide: ferrous metals
Green silicon carbide: non-ferrous metals
Standards: ANSI B7.1



General use for different applications

Does not overheat the workpiece, increasing productivity

Comes with different arbor bushings (from 1/2" to 7/8")

Part Number	Materials	Max rpm	Grit
MAO6011G	Brown aluminum oxide	4140	Coarse 36/46
MAO6011M	Brown aluminum oxide	4140	Medium 60/80
MAO6011F	Brown aluminum oxide	4140	Fine 100/120
MAC6011M	Green silicon carbide	4140	Medium 60
MAC6011F	Green silicon carbide	4140	Fine 80
MAC6011E	Green silicon carbide	4140	Extra-fine 120



SURFX

DE/FROM **CROMSON**

SURFX TR type deburring and surface finishing discs

A **IN** **AL**

Aluminum oxide
Standards: ANSI B7.1



- ✘ SURFX discs are made of non-woven materials and are designed for aeronautical industry.
- ✘ The evenly distributed layer of grain across the product prolongs its lifespan since the grain doesn't rest on the top of the fibers.
- ✘ For surface cleaning and preparation, get a higher level of material removal, a longer lifespan and a burr-free finish, even on high-nickel alloys.
- ✘ The next generation resin prevents clogging on the disc, transferring grinding residue or bonding to the work piece - even on aluminum or high-nickel alloys.



IDEAL FOR THE AEROSPACE INDUSTRY

Specially designed resin for smear-free surfaces

Dimension	Part number per grain type				Box
	Coarse	Medium	Fine	Very Fine	
2"	TR020030	TR020020	TR020010	TR020000	x25
3"	TR030030	TR030020	TR030010	TR030000	x25

DELTA CARB TR type coating removal discs



Silicon carbide
Standards: ANSI B7.1



Quick change method offers faster and more aggressive cutting with improved finish

Ideal for stripping coatings on a variety of materials, such as wood, steel, aluminum, asphalt, concrete, stainless steel, plastic, stone, nickel, tile and drywall

Open structure minimizes clogging

Good alternative to wire and steel brushes

Does not rust



Part Number	Size	Grit	Box
MD0200TR	2"	Very coarse	x10
MD0300TR	3"	Very coarse	x10

TR type disc holder

Standards: ANSI B7.1

Quick clamping / loosening (TR) system allows tool changes that improve productivity while reducing downtime

Part Number	Size	Density
DS0200TR	2"	Medium
DS0300TR	3"	Medium



ALPHA CUT Type 41 cut-off wheels - steel

Aluminum oxide cut-off wheel for gas saws



Fast and efficient cuts without burrs in steel



Two reinforced layers for increased safety

Designed for general cutting of all steel and stainless steel parts, including steel structure for tarred steel pipes, sheet metal, cables and solid parts of medium to small diameters

Part Number	Size	Packaging
MT411418A	14 x 1/8 x 20 mm	x 10

ALPHA CUT Type 41 cut-off wheels - concrete

Silicon carbide cut-off wheel for gas saws



Fast and efficient concrete cutting



Two reinforced layers for more safety

Designed for cutting bricks, blocks, concrete or other masonry materials

Part Number	Size	Packaging
MT411418B	14 x 1/8 x 20 mm	x 10



Abrasive cloth rolls

Aluminum oxide
Standards: ANSI B7.1

Durability and uniform sanding

Cotton cloth backing offers high resistance and flexibility for various uses

Different grits available

Part Number	Size	Grit
RA112080	1-1/2" x 50 yd.	80
RA112100	1-1/2" x 50 yd.	100
RA112120	1-1/2" x 50 yd.	120
RA112150	1-1/2" x 50 yd.	150
RA112180	1-1/2" x 50 yd.	180
RA112280	1-1/2" x 50 yd.	280
RA112320	1-1/2" x 50 yd.	320



Abrasive roll dispenser and shop roll kit

Perforated bracket for wall hanging

Easily allows cutting strips to a desired length

General purpose shop roll kit with grit 80, 100, 120, 150 and 180

Part Number KITPRA5

Choose an assortment of five shop rolls from our wide range of grits 80 to 320

Dispenser sold without rolls

Part Number PRA5



ASK FOR OUR CUTTING TOOL CATALOG

with its 4 complete product ranges and 4,500 items



DISCOVER OUR
MILLING

RECORD

Steels - stainless steel
2 - 4 fl. (square, radius
and ball nose)

STAR

Stainless steel - cast iron
- alloyed steel
4 - 5 - 7 fl. (square, radius)

ALLIANCE

Titanium
4 - 5 fl. (square, radius)

PISTON

Hardened steel up to 60 HRC
6 fl. (square, radius)

TURBINE

Roughing, steels
- stainless steel
- exotic 4 fl. (chamfer)

OXYGEN

High Speed Machining (HSM)
<60 HRC. 4-5 fl. (wide radius
for high feed)

TAPERMILL

Pre-machining NPT Thread
4 fl. (conical)

DRIVER

Finishing mold (up to 60 HRC)
2 fl. (ball nose)

MOTION

Aluminum
2-3 fl. (square, radius
and ball nose)

BOSS

Roughing - aluminum
3 fl. (chamfer)

MAGNAT

Steels - stainless steel - exotic
5 fl. (square, radius)

PERFORMANCE

Titanium - super Alloys
- stainless steel - 4 fl. (square,
radius and ball nose)

BOOSTER

Super Alloys - titanium
- stainless steel
5-7-9 fl. (square, radius)



DISCOVER OUR
DRILLING

EFFICIENCY - C1000

Materials < 48 HRC
External fluid (3xD)

EFFICIENCY - C1100

Materials < 48HRC
Internal coolant supply (3xD)

CROMINOX - C2100

Stainless steel - titanium - inconel
Internal coolant supply (3-5xD)

MINIATURE - C3100

Steels - stainless steel - PH
Internal coolant supply (5-8-12xD)

CROMSTEEL - C4100

Steels - cast iron - hardened steel
Internal coolant supply (3-5-8xD)

CONCENTRICITY - C5100

Concentricity - coaxiality
Internal coolant supply (5-8-12xD)
Double margin

HIGH PRECISION - C6100

Surface finish, tolerance
Internal coolant supply (5xD) 4 fl.

DRILLREAM - C7100

Simultaneous drilling / boring
Internal coolant supply (3-5xD)
Triple margin

CROMALU - C8100

Aluminum - Brass - Copper
Internal coolant supply (3-5-12xD)

**HIGH PERFORMANCE
C9100**

Steels -
stainless steel - cast iron (high feed)
Internal coolant supply (3-5-8xD)

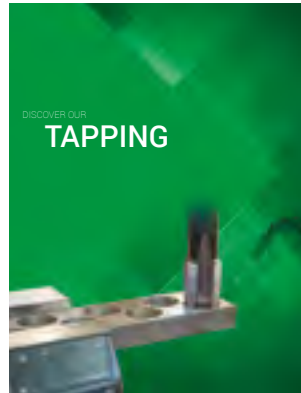

DISCOVER OUR
TAPPING

CRP3

Materials < 25 HRC
Spiral Point and Spiral Flute

**CRPS
Din / ANSI / NPT**

Materials < 35 HRC
Spiral Point and Spiral Flute

CRM

Stainless steel - alloyed steel
Spiral Point and Spiral Flute

CRS

Tool steel - titanium - nickel
Spiral Point and Spiral Flute

CRN

Aluminum - Steel <25 HRC
Spiral Point and Spiral Flute
Rolled thread

HAND TAP

Ferrous and non-ferrous
Taper, plug and bottoming

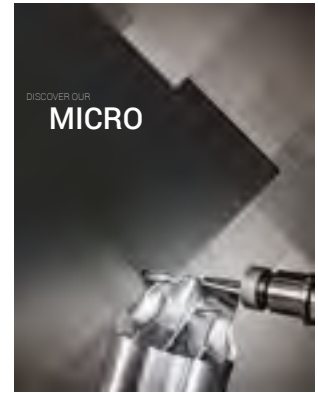

DISCOVER OUR
MICRO

CENTER DRILL

60° (double) HSS / carbide
Short and long

MULTI-STEP DRILL

HSS-E
Thin sheet material

MINIATURE DRILL

Carbide
0.10 to 1.00mm
External fluid

PROFILING END DRILL

Carbide
Micro ball nose 220°

BALL NOSE END MILL

Carbide
Micro hemispherical

CHAMFERING END MILL

Carbide - 90° and 60°
Profiling

THREADING END MILL

Carbide (thread M0.8 to M10)
CNC interpolation

ENGRAVING TOOL

Carbide
Tip : .05 to .20mm

COUNTERSINK

HSS-E and carbide
90° and 82°

**CORNER ROUNDING
END MILL**

Carbide
Radius : 0.5 to 3.0mm

MICRO END MILL

Carbide (1.5-5-8xD)
Steel - hardened steel <67 HRC,
titanium, aluminum

**O-RING AND CIRCLIP
END MILL**

Carbide 1.4 to 3.8mm



**CUTTING
TOOLS**

Expertise • Quality • Innovation

cromson.com

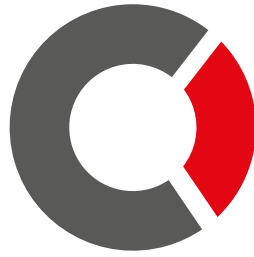

CUTTING TOOLS

ONE MOTTO AND A SINGLE GOAL:
TO PROVIDE A HIGH-QUALITY RESULT WITH POWERFUL TOOLS



EXPERTISE

Products researched and designed for professional use that meet or exceed industry standards



QUALITY

High-quality materials meeting the specifications and criteria of our experts



INNOVATION

Ease of use and adequate tools for all types of applications

90°/82° Countersinks - 3 flutes

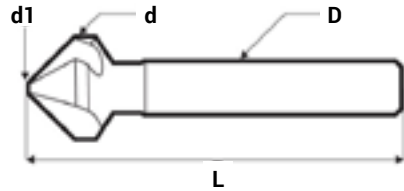

Material : HSS-E Cobalt / carbide
 Series : M08 - Metric / SAE
 Use : Machine

High performance countersink is a highly improved version of the traditional multiflute milling cutter :

- grooves opened wide to allow chip evacuation
- high positive cut
- constant profile relief for easier regrind
- dimensions are in accordance with 90° and 82° screw caps
- we recommend the usage of coolant

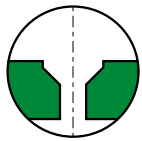

90° COUNTERSINK

Part Number M0805 HSS Co	Part Number M0805-C HSS Co TiN	Part Number M8090 Carbide	Diameter d Metric	Diameter d SAE	d1 max	D h9	L +/-1
77200300	77200305	77200500	6.30		1.50	5.00	45
77200400	77200405		6.35	1/4	1.50	6.35	45
77200410	77200415		7.93	5/16	2.00	6.35	45
	77200365	77200510	8.30		2.50	6.00	50
77200420	77200425		9.52	3/8	2.50	6.35	50
77200310	77200315	77200520	10.40			6.00	50
77200320	77200325	77200530	12.40		2.80	8.00	56
77200430	77200435		12.70	1/2	2.90	6.35	50
77200440	77200445		15.87	5/8	3.20	9.52	60
77200330	77200335	77200540	16.50		3.20	8.00	56
77200450	77200455		19.05	3/4	3.50	9.52	60
77200340	77200345	77200550	20.50		3.50	10.00	63
77200350	77200355		25.00		3.80	10.00	67
77200460	77200465		25.40	1	3.80	9.52	70

82° COUNTERSINK

Part Number M0882 HSS Co		Diameter d Metric	Diameter d SAE	d1 max	D h9	L +/-1
77200600		6.35	1/4	1.50	6.35	45
77200610		7.93	5/16	2.00	6.35	45
77200620		9.52	3/8	2.50	6.35	50
77200630		12.70	1/2	2.90	6.35	50
77200640		15.87	5/8	3.20	9.52	60
77200650		19.05	3/4	3.50	9.52	60
77200660		25.40	1	3.80	9.52	70

HSS Hand taps sets - metric or SAE



Material: HSS - High speed steel
 General application: Ferrous and non-ferrous
 Use : Manual
 Hole type: Through bore or blind hole
 Finish/Coating: Bright
 Tap length: Standard



Part Number	Description	Diameter Thread	Number Thread	Number flutes	Thread limit	OAL	Tap length
76004401	HSS - 6-32-NC	6	32	3	H3	2	11/16
76004411	HSS - 8-32-NC	8	32	4	H3	2-1/8	3/4
76004431	HSS - 10-24-NC	10	24	4	H3	2-3/8	7/8
76004441	HSS - 12-24-NC	12	24	4	H3	2-3/8	15/16
76004461	HSS - 10-32-NF	10	32	4	H3	2-3/8	7/8
76004471	HSS - 1/4-20-NC	1/4	20	4	H3	2-1/2	1
76004491	HSS - 1/4-28-NF	1/4	28	4	H3	2-1/2	1
76004511	HSS - 5/16-18-NC	5/16	18	4	H3	2-23/32	1-1/8
76004521	HSS - 5/16-24-NF	5/16	24	4	H3	2-23/32	1-1/8
76004531	HSS - 3/8-16-NC	3/8	16	4	H3	2-15/16	1-1/4
76004551	HSS - 3/8-24-NF	3/8	24	4	H3	2-15/16	1-1/4
76004561	HSS - 7/16-14-NC	7/16	14	4	H3	3-5/32	1-7/16
76004581	HSS - 7/16-20-NF	7/16	20	4	H3	3-5/32	1-7/16
76004591	HSS - 1/2-13-NC	1/2	13	4	H3	3-3/8	1-11/16
76004611	HSS - 1/2-20-NF	1/2	20	4	H3	3-3/8	1-11/16
76004621	HSS - 9/16-12-NC	9/16	12	4	H3	3-19/32	1-11/16
76004641	HSS - 9/16-18-NF	9/16	18	4	H3	3-19/32	1-11/16
76004651	HSS - 5/8-11-NC	5/8	11	4	H3	3-13/16	1-13/16
76004671	HSS - 5/8-18-NF	5/8	18	4	H3	3-13/16	1-13/16
76004681	HSS - 3/4-10-NC	3/4	10	4	H3	4-1/4	2
76004701	HSS - 3/4-16-NF	3/4	16	4	H3	4-1/4	2



Part Number	Description	Diameter Thread	Number Thread	Number flutes	Thread limit	OAL	Tap length
76004801	HSS - M3-0.5	M3	0.5	3	D3	1-15/16	5/8
76004811	HSS - M4-0.7	M4	0.7	3	D4	2-1/8	3/4
76004831	HSS - M5-0.8	M5	0.8	3	D4	2- 3/8	7/8
76004841	HSS - M6-1	M6	1	4	D5	2-1/2	1
76004861	HSS - M8-1.25	M8	1.25	4	D5	2-23/32	1-1/8
76004871	HSS - M10-1.25	M10	1.25	4	D5	2-15/16	1-1/4
76004891	HSS - M10-1.5	M10	1.5	4	D6	2-15/16	1-1/4
76004901	HSS - M12-1.75	M12	1.75	4	D6	3-3/8	1-21/32

HSS SAE Hand taps



Material: HSS - High speed steel
 General application : Ferrous and non-ferrous
 Use: Manual
 Hole type: Through bore or blind hole
 Finish/Coating: Bright
 Tap length: Standard



Part Number	Description	Type of finish	Diameter Thread	Number Thread	Number flutes	Thread limit	OAL	Tap length
76004400	HSS - 6-32 -NC1	TAPER	6	32	3	H3	2	11/16
76004405	HSS - 6-32 -NC2	PLUG	6	32	3	H3	2	11/16
76004410	HSS - 6-32 -NC3	BOTTOMING	6	32	3	H3	2	11/16
76004415	HSS - 8-32 -NC1	TAPER	8	32	4	H3	2-1/8	3/4
76004420	HSS - 8-32 -NC2	PLUG	8	32	4	H3	2-1/8	3/4
76004425	HSS - 8-32 -NC3	BOTTOMING	8	32	4	H3	2-1/8	3/4
76004430	HSS - 10-24 -NC1	TAPER	10	24	4	H3	2-3/8	7/8
76004435	HSS - 10-24 -NC2	PLUG	10	24	4	H3	2-3/8	7/8
76004440	HSS - 10-24 -NC3	BOTTOMING	10	24	4	H3	2-3/8	7/8
76004445	HSS - 12-24 -NC1	TAPER	12	24	4	H3	2-3/8	15/16
76004450	HSS - 12-24 -NC2	PLUG	12	24	4	H3	2-3/8	15/16
76004455	HSS - 12-24 -NC3	BOTTOMING	12	24	4	H3	2-3/8	15/16
76004460	HSS - 10-32 -NF1	TAPER	10	32	4	H3	2-3/8	7/8
76004465	HSS - 10-32 -NF2	PLUG	10	32	4	H3	2-3/8	7/8
76004470	HSS - 10-32 -NF3	BOTTOMING	10	32	4	H3	2-3/8	7/8
76004475	HSS - 1/4-20 -NC1	TAPER	1/4	20	4	H3	2-1/2	1
76004480	HSS - 1/4-20 -NC2	PLUG	1/4	20	4	H3	2-1/2	1
76004485	HSS - 1/4-20 -NC3	BOTTOMING	1/4	20	4	H3	2-1/2	1
76004490	HSS - 1/4-28 -NF1	TAPER	1/4	28	4	H3	2-1/2	1
76004495	HSS - 1/4-28 -NF2	PLUG	1/4	28	4	H3	2-1/2	1.
76004500	HSS - 1/4-28 -NF3	BOTTOMING	1/4	28	4	H3	2-1/2	1
76004505	HSS - 5/16-18 -NC1	TAPER	5/16	18	4	H3	2-23/32	1-1/8
76004510	HSS - 5/16-18 -NC2	PLUG	5/16	18	4	H3	2-23/32	1-1/8
76004515	HSS - 5/16-18 -NC3	BOTTOMING	5/16	18	4	H3	2-23/32	1-1/8
76004520	HSS - 5/16-24 -NF1	TAPER	5/16	24	4	H3	2-23/32	1-1/8
76004525	HSS - 5/16-24 -NF2	PLUG	5/16	24	4	H3	2-23/32	1-1/8
76004530	HSS - 5/16-24 -NF3	BOTTOMING	5/16	24	4	H3	2-23/32	1-1/8
76004535	HSS - 3/8-16 -NC1	TAPER	3/8	16	4	H3	2-15/16	1-1/4
76004540	HSS - 3/8-16 -NC2	PLUG	3/8	16	4	H3	2-15/16	1-1/4
76004545	HSS - 3/8-16 -NC3	BOTTOMING	3/8	16	4	H3	2-15/16	1-1/4
76004550	HSS - 3/8-24 -NF1	TAPER	3/8	24	4	H3	2-15/16	1-1/4
76004555	HSS - 3/8-24 -NF2	PLUG	3/8	24	4	H3	2-15/16	1-1/4



**CUTTING
TOOLS**

Expertise • Quality • Innovation

cromson.com

HSS SAE Hand taps



Material: HSS - High speed steel
 General application : Ferrous and non-ferrous
 Use: Manual
 Hole type: Through bore or blind hole
 Finish/Coating: Bright
 Tap length: Standard



Part Number	Description	Type of finish	Diameter Thread	Number Thread	Number flutes	Thread limit	OAL	Tap length
76004560	HSS - 3/8-24 -NF3	BOTTOMING	3/8	24	4	H3	2-15/16	1-1/4
76004565	HSS - 7/16-14 -NC1	TAPER	7/16	14	4	H3	3-5/32	1-7/16
76004570	HSS - 7/16-14 -NC2	PLUG	7/16	14	4	H3	3-5/32	1-7/16
76004575	HSS - 7/16-14 -NC3	BOTTOMING	7/16	14	4	H3	3-5/32	1-7/16
76004580	HSS - 7/16-20 -NF1	TAPER	7/16	20	4	H3	3-5/32	1-7/16
76004585	HSS - 7/16-20 -NF2	PLUG	7/16	20	4	H3	3-5/32	1-7/16
76004590	HSS - 7/16-20 -NF3	BOTTOMING	7/16	20	4	H3	3-5/32	1-7/16
76004595	HSS - 1/2-13 -NC1	TAPER	1/2	13	4	H3	3-3/8	1-11/16
76004600	HSS - 1/2-13 -NC2	PLUG	1/2	13	4	H3	3-3/8	1-11/16
76004605	HSS - 1/2-13 -NC3	BOTTOMING	1/2	13	4	H3	3-3/8	1-11/16
76004610	HSS - 1/2-20 -NF1	TAPER	1/2	20	4	H3	3-3/8	1-11/16
76004615	HSS - 1/2-20 -NF2	PLUG	1/2	20	4	H3	3-3/8	1-11/16
76004620	HSS - 1/2-20 -NF3	BOTTOMING	1/2	20	4	H3	3-3/8	1-11/16
76004625	HSS - 9/16-12 -NC1	TAPER	9/16	12	4	H3	3-19/32	1-11/16
76004630	HSS - 9/16-12 -NC2	PLUG	9/16	12	4	H3	3-19/32	1-11/16
76004635	HSS - 9/16-12 -NC3	BOTTOMING	9/16	12	4	H3	3-19/32	1-11/16
76004640	HSS - 9/16-18 -NF1	TAPER	9/16	18	4	H3	3-19/32	1-11/16
76004645	HSS - 9/16-18 -NF2	PLUG	9/16	18	4	H3	3-19/32	1-11/16
76004650	HSS - 9/16-18 -NF3	BOTTOMING	9/16	18	4	H3	3-19/32	1-11/16
76004655	HSS - 5/8-11 -NC1	TAPER	5/8	11	4	H3	3-13/16	1-13/16
76004660	HSS - 5/8-11 -NC2	PLUG	5/8	11	4	H3	3-13/16	1-13/16
76004665	HSS - 5/8-11 -NC3	BOTTOMING	5/8	11	4	H3	3-13/16	1-13/16
76004670	HSS - 5/8-18 -NF1	TAPER	5/8	18	4	H3	3-13/16	1-13/16
76004675	HSS - 5/8-18 -NF2	PLUG	5/8	18	4	H3	3-13/16	1-13/16
76004680	HSS - 5/8-18 -NF3	BOTTOMING	5/8	18	4	H3	3-13/16	1-13/16
76004685	HSS - 3/4-10 -NC1	TAPER	3/4	10	4	H3	4-1/4	2
76004690	HSS - 3/4-10 -NC2	PLUG	3/4	10	4	H3	4-1/4	2
76004695	HSS - 3/4-10 -NC3	BOTTOMING	3/4	10	4	H3	4-1/4	2
76004700	HSS - 3/4-16 -NF1	TAPER	3/4	16	4	H3	4-1/4	2
76004705	HSS - 3/4-16 -NF2	PLUG	3/4	16	4	H3	4-1/4	2
76004710	HSS - 3/4-16 -NF3	BOTTOMING	3/4	16	4	H3	4-1/4	2



HSS metric hand taps



Material: HSS - High speed steel
 General application: Ferrous and non-ferrous
 Use: Manual
 Hole type: Through bore or blind hole
 Finish/Coating: Bright
 Tap length: Standard

Part Number	Description	Type of finish	Diameter Thread	Number Thread	Number flutes	Thread limit	OAL	Tap length
76004800	HSS - M3-0.5 -1	TAPER	M3	0.5	3	D3	1-15/16	5/8
76004805	HSS - M3-0.5 -2	PLUG	M3	0.5	3	D3	1-15/16	5/8
76004810	HSS - M3-0.5 -3	BOTTOMING	M3	0.5	3	D3	1-15/16	5/8
76004815	HSS - M4-0.7 -1	TAPER	M4	0.7	3	D4	2-1/8	3/4
76004820	HSS - M4-0.7 -2	PLUG	M4	0.7	3	D4	2-1/8	3/4
76004825	HSS - M4-0.7 -3	BOTTOMING	M4	0.7	3	D4	2-1/8	3/4
76004830	HSS - M5-0.8 -1	TAPER	M5	0.8	3	D4	2-3/8	7/8
76004835	HSS - M5-0.8 -2	PLUG	M5	0.8	3	D4	2-3/8	7/8
76004840	HSS - M5-0.8 -3	BOTTOMING	M5	0.8	3	D4	2-3/8	7/8
76004845	HSS - M6-1 -1	TAPER	M6	1	4	D5	2-1/2	1
76004850	HSS - M6-1 -2	PLUG	M6	1	4	D5	2-1/2	1
76004855	HSS - M6-1 -3	BOTTOMING	M6	1	4	D5	2-1/2	1
76004860	HSS - M8-1.25 -1	TAPER	M8	1.25	4	D5	2-23/32	1-1/8
76004865	HSS - M8-1.25 -2	PLUG	M8	1.25	4	D5	2-23/32	1-1/8
76004870	HSS - M8-1.25 -3	BOTTOMING	M8	1.25	4	D5	2-23/32	1-1/8
76004875	HSS - M10-1.25 -1	TAPER	M10	1.25	4	D5	2-15/16	1-1/4
76004880	HSS - M10-1.25 -2	PLUG	M10	1.25	4	D5	2-15/16	1-1/4
76004885	HSS - M10-1.25 -3	BOTTOMING	M10	1.25	4	D5	2-15/16	1-1/4
76004890	HSS - M10-1.5 -1	TAPER	M10	1.5	4	D6	2-15/16	1-1/4
76004895	HSS - M10-1.5 -2	PLUG	M10	1.5	4	D6	2-15/16	1-1/4
76004900	HSS - M10-1.5 -3	BOTTOMING	M10	1.5	4	D6	2-15/16	1-1/4
76004905	HSS - M12-1.75 -1	TAPER	M12	1.75	4	D6	3-3/8	1-21/32
76004910	HSS - M12-1.75 -2	PLUG	M12	1.75	4	D6	3-3/8	1-21/32
76004915	HSS - M12-1.75 -3	BOTTOMING	M12	1.75	4	D6	3-3/8	1-21/32

Drill press vise



Fixed hardened steel jaws with horizontal (1) and vertical (3) V's
 Ideal for clamping thin parts, metals, plastics, wood, etc.

Securely hold workpieces for reliable and accurate drilling
 Small footprint thanks to the clamping screw that fits into the operating handle

3 machining sides

3 positions: on base, on edge and on front face

Stability assured thanks to lateral mounting notches

Part Number	Length	Opening (in)
EA7344	344 mm - 13-9/16"	4-5/16"

SIGMA+ double cut carbide burrs

The quality of the tungsten carbide substrate increases durability, performance, tooth hardness and cutting edges



Increased material removal and reduced chip breakage

Universal cut provides versatility and adaptability to grinding machines and automatic numerical control machines

Part Number	D1	L1	D2	L2
BC000SA3	3/8"	3/4"	1/4"	2-1/2"
BC000SA5	1/2"	1"	1/4"	2-3/4"
BC000SC3	3/8"	3/4"	1/4"	2-1/2"
BC000SC5	1/2"	1"	1/4"	2-3/4"
BC000SF3	3/8"	3/4"	1/4"	2-1/2"
BC000SF5	1/2"	1"	1/4"	2-3/4"

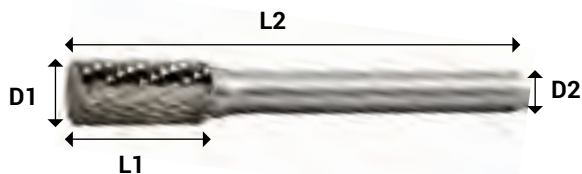

Type SA - Cylindrical without End Cut



Finishing contours and right angle corners

Type SC - Cylindrical without Radius



Better tool control provides smoother operation

Type SF - Tree with Radius



Round edges and concave cuts

Multi-step drills



Material :

63 HRC Hardness for the machining of steels up to 800 N/mm²

Copper, brass, bronze, aluminum up to 6% Si

Straight flute

Series : M02 - Metric

Use : Machine

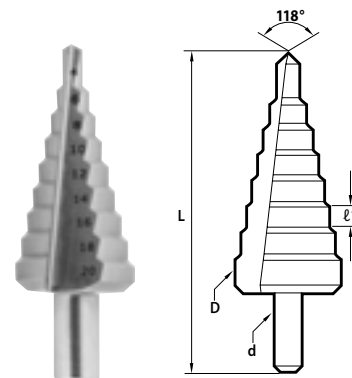

Part Number	Diameter	Capacity Opening	L	l1	d
77100400	12	4, 5, 6, 7, 8, 9, 10, 11, 12	79	5	6
77100410	20	4, 6, 8, 10, 12, 14, 16, 18, 20	67	3	8
77100420	30	4, 6, 8, 10, 12, 14, 16, 18, 20, 22, 24, 26, 28, 30	100	4	10
77100430	38	6, 9, 13, 16, 19, 21, 23, 26, 29, 32, 35, 38	100	4	10
77100440	12, 20 and 30	Set includes 77100400 - 77100410 et 77100420			



HSS BORADO mechanic's length drills - intensive use



Material: HSS - High speed steel
 Use: Manual and machine
 Finish: Black & Gold
 Split Point: 135 °



Nitride treated, heavy-duty construction increases tool life and performance
Black & Gold surface treatment for maximum lubricity
Usable in a wide range of materials including stainless steel
3-flat shank helps to reduce slippage



Part Number	Diameter	Type Thread	Total length	Flute length
CD0116	1/16	Round	1-7/8	7/8
CD0564	5/64	Round	2	1
CD0332	3/32	Round	2-1/4	1-1/4
CD0764	7/64	Round	2-3/8	1-5/16
CD0108	1/8	Round	2-1/2	1-7/16
CD0964	9/64	Round	2-5/8	1-9/16
CD0532	5/32	Round	2-3/4	1-11/16
CD1164	11/64	Round	2-7/8	1-13/16
CD0316	3/16	3-Flat	3	1-7/8
CD1364	13/64	3-Flat	3-1/8	1-15/16
CD0732	7/32	3-Flat	3-1/4	2
CD1564	15/64	3-Flat	3-3/8	2-1/16
CD0104	1/4	3-Flat	3-1/2	2-3/32
CD1764	17/64	3-Flat	3-5/8	2-1/8
CD0932	9/32	3-Flat	3-3/4	2-1/4
CD1964	19/64	3-Flat	3-7/8	2-3/8
CD0516	5/16	3-Flat	4	2-1/2
CD2164	21/64	3-Flat	4-1/16	2-9/16
CD1132	11/32	3-Flat	4-1/8	2-5/8
CD2364	23/64	3-Flat	4-3/16	2-11/16
CD0308	3/8	3-Flat	4-1/4	2-11/16
CD2564	25/64	3-Flat	4-5/16	2-3/4
CD1332	13/32	3-Flat	4-3/8	2-13/16
CD2764	27/64	3-Flat	4-7/16	2-7/8
CD0716	7/16	3-Flat	4-1/2	2-15/16
CD2964	29/64	3-Flat	4-5/8	3
CD1532	15/32	3-Flat	4-3/4	3-1/8
CD3164	31/64	3-Flat	4-7/8	3-1/4
CD0102	1/2	3-Flat	5	3-3/8

Set of 8 HSS BORADO reduced shank drills - 1/2" shank

Material: HSS - High speed steel
 Use: Manual and machine
 Finish: Black & Gold
 Split Point: 118 °



Nitride treated, heavy-duty construction increases tool life and performance
Black & Gold surface treatment for maximum lubricity
Usable in a wide range of materials including difficult to machine materials such as stainless steel

Part Number	Diameter	Type Thread	Total length	Flute length
CD3364	33/64	1/2 - 3-Flat	6	3
CD1732	17/32	1/2 - 3-Flat	6	3
CD3564	35/64	1/2 - 3-Flat	6	3
CD0916	9/16	1/2 - 3-Flat	6	3
CD3764	37/64	1/2 - 3-Flat	6	3
CD1932	19/32	1/2 - 3-Flat	6	3
CD3964	39/64	1/2 - 3-Flat	6	3
CD0508	5/8	1/2 - 3-Flat	6	3
CD4164	41/64	1/2 - 3-Flat	6	3
CD2132	21/32	1/2 - 3-Flat	6	3
CD4364	43/64	1/2 - 3-Flat	6	3
CD1116	11/16	1/2 - 3-Flat	6	3
CD4564	45/64	1/2 - 3-Flat	6	3
CD2332	23/32	1/2 - 3-Flat	6	3
CD4764	47/64	1/2 - 3-Flat	6	3
CD0304	3/4	1/2 - 3-Flat	6	3
CD4964	49/64	1/2 - 3-Flat	6	3
CD2532	25/32	1/2 - 3-Flat	6	3
CD5164	51/64	1/2 - 3-Flat	6	3
CD1316	13/16	1/2 - 3-Flat	6	3
CD5364	53/64	1/2 - 3-Flat	6	3
CD2732	27/32	1/2 - 3-Flat	6	3
CD5564	55/64	1/2 - 3-Flat	6	3
CD0708	7/8	1/2 - 3-Flat	6	3
CD5764	57/64	1/2 - 3-Flat	6	3
CD2932	29/32	1/2 - 3-Flat	6	3
CD5964	59/64	1/2 - 3-Flat	6	3
CD1516	15/16	1/2 - 3-Flat	6	3
CD6164	61/64	1/2 - 3-Flat	6	3
CD3132	31/32	1/2 - 3-Flat	6	3
CD6364	63/64	1/2 - 3-Flat	6	3
CD0001	1	1/2 - 3-Flat	6	3



Set of 8 HSS BORADO drill bits - 1/2" shank



Metal box
 Material: HSS - High speed steel
 Finish: Black & Gold
 Split Point: 118 °
 Shank type : 1/2 3-Flats

Part Number	Size
CD08M	9/16" to 1" by 16ths



Set of 29 HSS BORADO drill bits - mechanic's length



Metal box
 Material: HSS - High speed steel
 Finish: Black & Gold
 Split Point: 135 °
 Shank type : 3-Flats

Part Number	Size
CD29M	1/16" to 1/2" by 64ths



Set of 29 HSS BORADO drill bits - mechanic's length



Plastic box
 Material: HSS - High speed steel
 Finish: Black & Gold
 Split Point: 135 °
 Shank type : 3-Flats

Part Number	Size
CD29P	1/16" to 1/2" by 64ths





MAINTENANCE

ONE MOTTO AND A SINGLE GOAL:
ENSURE THE SUCCESS OF YOUR PROJECTS
IN AN ENVIRONMENT OF CONTINUED PERFORMANCE



Products researched and designed for professional use that meet or exceed industry standards



Tools that meet your expectations and ensure a job well done



A wide range that adapts to all your professional and personal projects



Suitable for all types of paints, dyes and varnishes
 Natural wood handle
 Poly/nylon bristles



Paint brush flat sash nylon

Part Number	Width	Thickness	Length
CR7200	1" - 25 mm	7/16" - 11 mm	2-1/4" - 57 mm
CR7201	2" - 50 mm	1/2" - 13 mm	2-1/2" - 64 mm
CR7202	3" - 75 mm	3/4" - 19 mm	2-3/4" - 70 mm



Paint brush angular sash nylon

Part Number	Width	Thickness	Length
CR7250	2" - 50 mm	1/2" - 13 mm	2-1/2" - 64 mm
CR7251	2-1/2" - 64 mm	5/8" - 16 mm	2-3/4" - 70 mm
CR7252	3" - 75 mm	5/8" - 16 mm	2-3/4" - 70 mm

Blue H.D.P.E. tarp - heavy duty

H.D.P.E. (High Density Polyethylene)
 Weave construction : 10 x 10
 GSM (Gram per square meter) : 110

Waterproof and resistant to chemicals, tears and mildew

Aluminum rust resistant grommets every 3'

Polyethylene Rope Reinforced edges



Part Number	Size
CR9000	6' x 8'
CR9001	8' x 10'
CR9002	10' x 12'
CR9003	10' x 15'
CR9004	15' x 20'
CR9005	18' x 24'
CR9006	20' x 30'
CR9007	30' x 40'
CR9008	30' x 50'
CR9009	40' x 50'
CR9010	40' x 60'





2 colours :

Natural White made of natural nylon for indoor use only

UV Black made of weather-resistant nylon good for indoor or outdoor use

Natural nylon cable ties

CSA approved

Easy to insert and pull through

Higher tensile strength achieved from one piece design

Part Number (x100)	Part Number (x1000)	Colour	Tensile strength	Length	Width	Thickness
CR9100	CR9101	Natural white	18 lb	4.10	.095	.042
CR9102	CR9103	Black UV	18 lb	4.10	.095	.042
CR9104	CR9105	Natural white	18 lb	6.18	.095	.042
CR9106	CR9107	Black UV	18 lb	6.18	.095	.042
CR9108	CR9109	Natural white	18 lb	8.10	.095	.042
CR9110	CR9111	Black UV	18 lb	8.10	.095	.042
CR9112	CR9113	Natural white	40 lb	5.80	.140	.049
CR9114	CR9115	Black UV	40 lb	5.80	.140	.049
CR9116	CR9117	Natural white	40 lb	8.80	.140	.049
CR9118	CR9119	Black UV	40 lb	8.80	.140	.049
CR9120		Natural white	40 lb	10.96	.140	.049
CR9121		Black UV	40 lb	10.96	.140	.049
CR9122		Natural white	40 lb	14.25	.140	.049
CR9123		Black UV	40 lb	14.25	.140	.049
CR9124	CR9125	Natural white	50 lb	7.50	.180	.052
CR9126	CR9127	Black UV	50 lb	7.50	.180	.052
CR9128		Natural white	50 lb	11.20	.180	.052
CR9129		Black UV	50 lb	11.20	.180	.052
CR9130		Natural white	50 lb	14.25	.180	.052
CR9131		Black UV	50 lb	14.25	.180	.052
CR9132		Natural white	50 lb	17.00	.180	.052
CR9133		Black UV	50 lb	17.00	.180	.052



Extendable LED flashlight with magnet

Aluminum construction with stainless steel clip

Instant maximum LED lighting

Flexible and directional rotation of the handle 360° for optimal visibility

4 LR44 batteries included

Part Number	Colour
CR7001	Blue
CR7002	Black
CR7003	Red



Magnet lifts up to 5 lbs

Extendable telescopic arm up to 22 inches





One-piece construction for increased strength and durability

Combines roll head and angle pry bar ends for better access in tight work areas

Round tapered handle and pinch point end to pry and lift heavy objects



Utility bar



Tempered Alloy steel
Electrostatic powder coating resistant to corrosion

Hexagonal shank for maximum comfort

Ideal for lifting heavy weights and heavy-duty work

Part Number	Length	Weight (lb)
CR7352	15"	1,5



Wrecking bars



Tempered Alloy steel
Electrostatic powder coating resistant to corrosion

Hexagonal shank for maximum comfort

Part Number	Length	Weight (lb)
CR7350	24"	4,25
CR7351	36"	6,25



Pry bar

Tempered Alloy steel
Electrostatic powder coating resistant to corrosion

Hexagonal shank for maximum comfort

Chisel and crow end are precision-ground

Part Number	Length	Weight (lb)
CR7353	60"	18

Winter shovels

Thermoformed molding

Poly blade offers flexibility in cold temperatures

Solid ash handle is stained to help prevent chipping, and water damage

D-style grip makes using this shovel comfortable and easy



Part Number	Type	Handle length	Blade width	Handle type
CR7404	Snow shovel	53.5"	14.5" x 7.5"	D
CR7405	Snow pusher	56"	20.5" x 6"	D
CR7406	Snow pusher	56.5"	25.5" x 5"	D



CR7406



CR7405



CR7404



Durable black tempered steel blade engineered to withstand heavy use
Solid ash handle is stained to help prevent chipping, and water damage



All-purpose shovel



Ideal for most applications

D-style grip makes using this shovel comfortable and easy

Part Number	Blade width	Length	Handle type	Weight (lb)
CR7400	11,25"	46.5"	D	5,2



Square-point shovel



Ideal for scooping and moving soil, gravel and other landscaping materials

Forward turned footsteps on the blade for additional leverage

Part Number	Blade width	Length	Handle type	Weight (lb)
CR7401	10.50"	61.5"	Long	3.8



Round-point shovel



Ideal for digging, planting and moving earth

Forward turned footsteps on the blade for additional leverage

Part Number	Blade width	Length	Handle type	Weight (lb)
CR7402	8.50"	63.5"	Long	4.2



Aluminum grain scoop N°8

Ideal for moving grain, seed, feed, fertilizers and other granulated materials

Aluminum blade is lightweight and durable

Handle: hardwood, natural finish

Part Number	Blade width	Length	Handle type	Weight (lb)
CR7403	13"	65"	Long	3.8

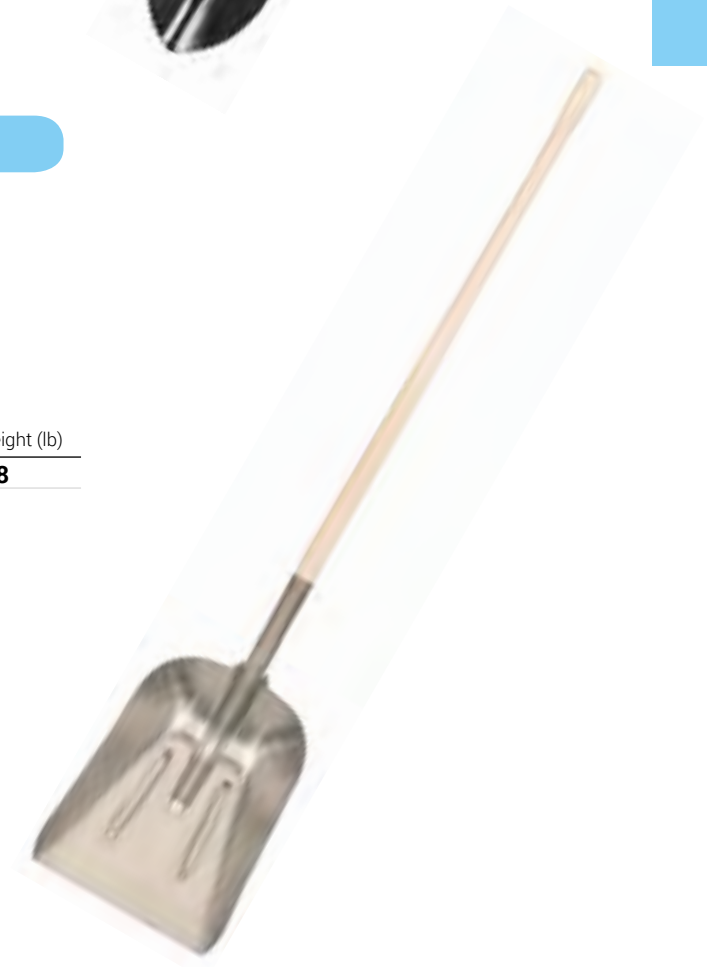



Utility knife with ratchet-lock blade

Stainless steel blade channel

Ergonomic non-slip grip

Ratchet locking mechanism

Ideal for cutting sturdy building materials such as drywall, linoleum, carpet and many others

Replacement steel blade: *CR7363*

Part Number	Blade width
<i>CR7360</i>	18 mm - 23/32"

Utility knife with slide-lock blade

Stainless steel blade channel

Plastic Handle

Slide locking mechanism

Replacement steel blade: *CR7364*

Part Number	Blade width
<i>CR7361</i>	9 mm - 11/32"



Self-loading knife for intensive use

Stainless steel blade channel

Ergonomic non-slip rubber grip

Slide lock mechanism automatically locks the blade to the desired size

Handle composed of five blades SK5 for ejection and fast loading

Ideal for cutting sturdy building materials such as drywall, linoleum, carpet and many others

Replacement steel blade: *CR7365*

Part Number	Blade width
<i>CR7362</i>	18 mm - 23/32"



Replacement steel blades

Steel

Package: x10

Part Number	Segments per blade	Blade width	Use with the model
<i>CR7363</i>	x 8	18 mm - 23/32"	<i>CR7360</i>
<i>CR7364</i>	x 12	9 mm - 11/32"	<i>CR7361</i>
<i>CR7365</i>	x 8	18 mm - 23/32"	<i>CR7362</i>





Pipe holder



Anvil

Forged steel vise with swivel-base

High tensile casting body with a machined anvil

Precision glide for effortless operation

Replaceable inserted jaws made of case-hardened chromium molybdenum steel

Professional quality for excellent stability

Supplied with 360° swivel base (removable for rigid base mounting)

Pipe holder

Part Number	Jaw size	Opening (in)
EA5125	125 mm - 5"	6-5/16"
EA6150	150 mm - 6"	7-15/32"

- High quality
- Long-lasting
- Resistant
- Sturdy



Removable magnetic jaw sets with prismatic surface

Aluminum

4 V-grooves for vertical (3) and horizontal (1) clamping of round parts

Upper rests to hold thin pieces

Magnetic mounting

Universal, fits on all 5" and 6" vises



Part Number	Jaw size
EA8125	125 mm - 5"
EA8150	150 mm - 6"

Quick-clamping woodworkers vise

Large clamping area

Clamping screws and chrome guides

Pre-drilled holes for mounting protective wooden jaws

The retractable stop with use of a bench hold-down increases clamping capacity

Trigger action releases the screw permitting quick opening or closing of the vise

Part Number	Length	Opening (in)
EA7225	225 mm - 8-7/8"	13-3/8"



Woodworkers vise

Large clamping area (150 x 40 mm)

Ideal for woodworking

Built-in plastic jaws incorporated to avoid marking parts

Part Number	Length	Opening (in)
EA7155	155 mm - 6-3/32"	5-15/16"



Multi-use folding table

- Portable
- Sturdy
- High stability

Wooden table top

Lateral steel corner protectors

45 mm diameter tube feet

Quick and easy assembly and disassembly

Part Number	CR7230		
Length	Width	Height	Weight (lb)
1100 mm	600 mm	820 mm	55
43-5/16"	23-5/8"	32-9/32"	



WARRANTY POLICY

CROMSON ensures that its products are manufactured according to industry standards and that each of them is guaranteed against manufacturing defects during its lifetime *

One-year limited warranty on material handling products used under normal conditions. Applies to defective parts (deformation, breakage, etc.) or premature wear (confirmed by the expertise of CROMSON technical services).



Any products in the CROMSON material handling range** that become defective under normal conditions of use during the warranty period will be exchanged free of charge by CROMSON.

For more details on application conditions and warranty terms of use, refer to page 6.

SAFETY GUIDE

This information is provided as an indication to the users of material handling products. Carefully read the instructions provided with the tools before using them.

Prevent serious accidents by taking simple precautions:

DO'S	DON'TS
<ul style="list-style-type: none"> • Ensure the safety of workers • Ensure that the free height of the load is enough to avoid a collision • Ensure that the chain is properly lodged in the pulleys and is not twisted, deformed or damaged. • Check the brake operation • Check the operation of the latch • Check the lubricant • Inspect the hooks for any nicks, gouges, cracks, and separation marks, or twists 	<ul style="list-style-type: none"> • Lift above the load conditions • Lift people or lift loads over people's heads • Use with defective parts • Use if the load is applied at the end of the hook • Hammer the lever • Use extension cords • Remove warning labels

*Product used for the intended application

** Included in this warranty: chain hoists, lever hoists, manual trolleys

COMMITMENT

Our material handling products are AMSE B30.11 and AMSE B30.16 certified.

Included:

- Nameplate
- Serial number
- Capacity
- Certificate of inspection and tested with declaration of conformity
- User Guide



MATERIAL HANDLING

ONE MOTTO AND A SINGLE GOAL:
EFFECTIVE SOLUTIONS ADAPTED TO YOUR NEEDS
IN COMPLIANCE WITH SAFETY STANDARDS



EXPERTISE

Products researched and designed for professional use that meet or exceed industry standards



QUALITY

Reliable and resistant materials to ensure safe working conditions



INNOVATION

A wide range combining durability, toughness and visibility

Trolleys CCM series

*Tested at 125% of rated capacity (certificate included)

Capacity of 1T and 2T

One-year warranty

ASME B30.11 Certified

Nameplate including serial number and capacity



SECURITY

Built-in bumpers to cushion the load in case of wheel malfunction and avoided risk of contact between wheels

ADAPTABLE

Safely compatible with a wide range of beam widths. H, I, straight, curved or edged

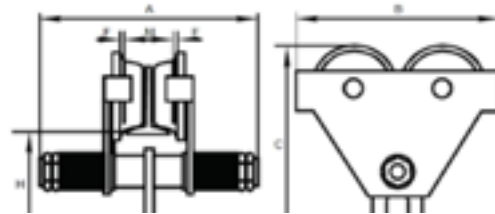

Model	Capacity	Rated capacity (lb)	Beam sole width (in)	Minimum bending radius (in)	A	B	C	H	Weight (lb)
CM1000	1 T	2200	2-1/2 to 5-1/2	40	10"	10-3/64"	9-7/64"	5-3/64"	26.50
CM2000	2 T	4400	3 to 6-1/2	48	11-9/16"	11-29/32"	10-15/16"	5-63/64"	48.50

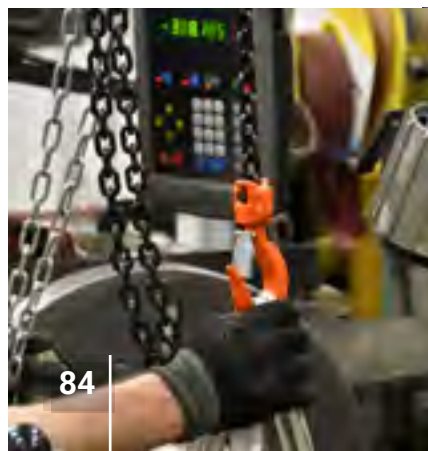

Chain hoists CPC series

*Tested at 150% of rated capacity (certificate included)

Capacity of 1/2T, 1T and 2T

One-year warranty

ASME B30.16 Certified

Nameplate including serial number and capacity

SECURITY

Weston brake system, slow folding of hooks with security latch in case of overload, orange finish

ADAPTABLE

Triple gear, exclusive first-grade asbestos-free disc to improve lifetime, high-quality 80 caliber lifting chain, bearings with armoured seals

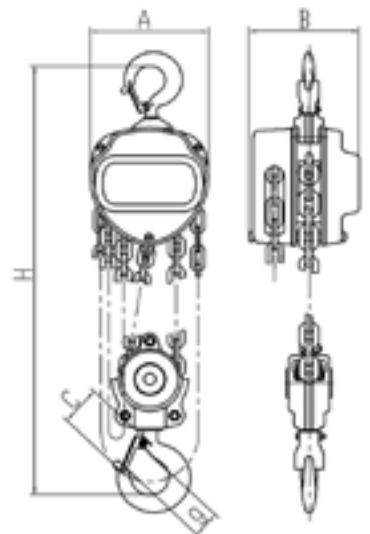

Model	PC05010	PC05020	PC10010	PC10020	PC20010	PC20020
Lifting capacity nominal (tons)	1/2	1/2	1	1	2	2
Standard lifting height (ft)	10	20	10	20	10	20
Clearance (in)	11-1/32	11-1/32	12-1/16	12-1/16	17-1/2	17-1/2
Number of chainfalls	1	1	1	1	1	1
Load chain diameter (mm)	6	6	6	6	8	8
Force to lift the rated load (lb)	49	49	68	68	102	102
Hand chain length required to lift a load 1 foot (in)	27	27	40	40	70	70
Product weight (lb)	19.80	30.80	24.20	35.40	38.63	54.69
A	4-15/16"	4-15/16"	5-3/4"	5-3/4"	7-1/4"	7-1/4"
B	4-13/16"	4-13/16"	5-1/2"	5-1/2"	6-1/4"	6-1/4"
C	1-3/8"	1-3/8"	1-3/4"	1-3/4"	2-1/16"	2-1/16"
G	1-1/16"	1-1/16"	1-5/16"	1-5/16"	1-5/16"	1-5/16"
H	11-1/32"	11-1/32"	12-1/16"	12-1/16"	17-1/2"	17-1/2"

Lever hoists CPL series

*Tested at 150% of rated capacity (certificate included)



Capacity of 3/4T and 1-1/2T

One-year warranty

ASME B30.16 Certified

Nameplate including serial number and capacity

SECURITY

Hooks with deformation indicator that allows maintenance, Weston brake system, orange finish

ADAPTABLE

High-quality 80 caliber lifting chain, designed to withstand impacts, cold-stamped steel, exclusive first-grade asbestos-free disc to extend lifetime

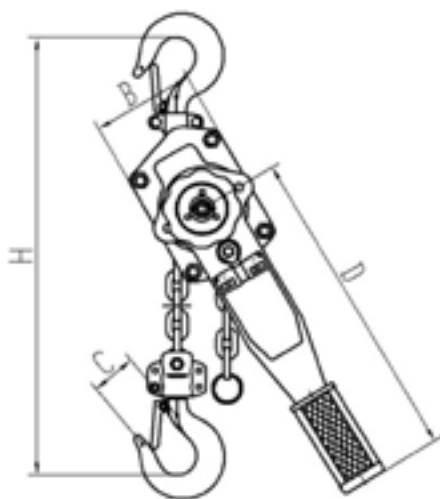

Model	PL07505	PL07510	PL15005	PL15010
Lifting capacity nominal (tons)	3/4	3/4	1-1/2	1-1/2
Standard lifting height (ft)	5	10	5	10
Number of chainfalls	1	1	1	1
Diameter of the loading chain (mm)	6	6	8	8
Force to lift the rated load (lb)	31	31	48	48
Length of the lever (in)	12	12	16-1/2	16-1/2
Minimum distance between brackets (in)	12	12	15	15
Product weight (lb)	13.20	15.40	26.40	28.70
A	5-7/8"	5-7/8"	6-3/4"	6-3/4"
B	3-1/2"	3-1/2"	3-7/8"	3-7/8"
C	1-1/2"	1-1/2"	1-7/8"	1-7/8"
D	12"	12"	16-1/2"	16-1/2"
H	12-3/4"	12-3/4"	15"	15"

Heavy-duty hand truck

Frame : aluminum
Wheels : rubber

Elastic strap to secure load

Part Number	Use	Maximum load
CR7000	Heavy-duty	260 lb

 **260 lb** Plate 15-1/4 x 11"



Folding hand truck

Frame : aluminum
Wheels : rubber

Elastic strap to secure the load

Part Number	Use	Maximum load
CR7100	Light duty	175 lb

 **175 lb** Plate 16-1/2" x 11-1/2"



Type 3 webbing slings - 2-ply

Standards: WSTDA-WS-1 / ASME B30.9

Polyester sling resistant to most chemicals

Non-resistant to acids, aldehydes, ethers and strong alkalines

Part Number	Length	Width	Vertical WLL	Choker WLL	Basket WLL
CR7313	3'	1"	3100 lb	2400 lb	6200 lb
CR7314	4'	1"	3100 lb	2400 lb	6200 lb
CR7300	6'	1"	3100 lb	2480 lb	6200 lb
CR7301	8'	1"	3100 lb	2480 lb	6200 lb
CR7311	10'	1"	3100 lb	2400 lb	6200 lb
CR7302	12'	1"	3100 lb	2480 lb	6200 lb
CR7303	2'	2"	6200 lb	4960 lb	12400 lb
CR7312	3'	2"	6200 lb	4960 lb	12400 lb
CR7304	4'	2"	6200 lb	4960 lb	12400 lb
CR7305	6'	2"	6200 lb	4960 lb	12400 lb
CR7306	8'	2"	6200 lb	4960 lb	12400 lb
CR7307	10'	2"	6200 lb	4960 lb	12400 lb
CR7308	12'	2"	6200 lb	4960 lb	12400 lb
CR7309	16'	2"	6200 lb	4960 lb	12400 lb
CR7310	20'	2"	6200 lb	4960 lb	12400 lb



Eyelet

2 ply

WLL = Working Load Limit



Safety instructions

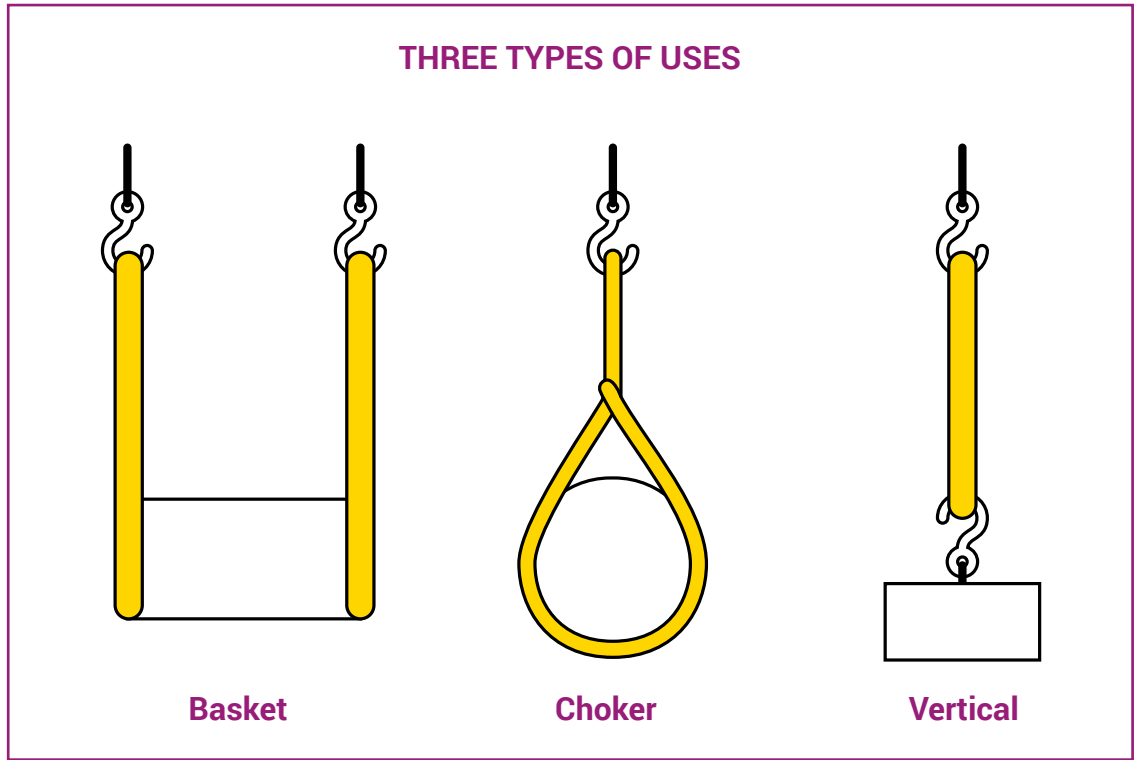

information label of product characteristics

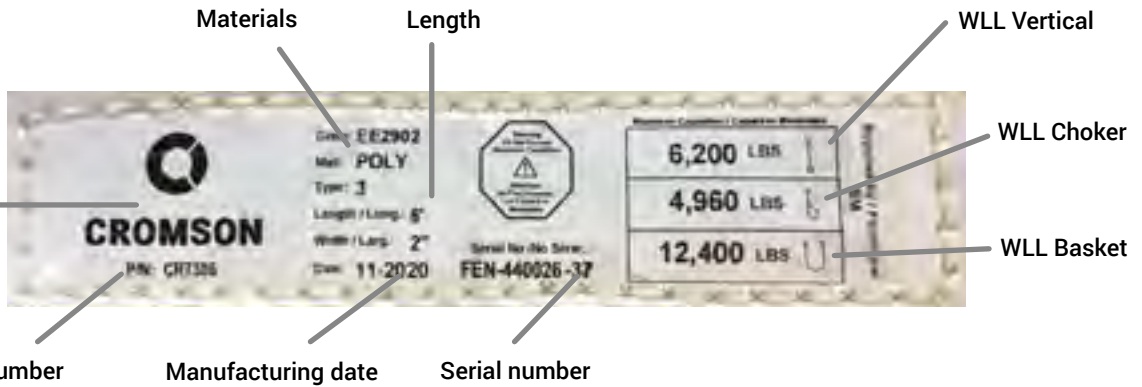

Ratchet straps

Standards: WSRDA-T1
 Polyester
 Iron (Steel) Buckle
 Hook type: Double J



Part Number	Length	Width	Breaking strength	WLL	Weight
CR7370	16'	1"	3 000 lb	1 500 lb	1.72 lb
CR7371	27'	2"	11 000 lb	5 000 lb	4.94 lb



SAFETY CONDITIONS

WARNING

Respect to the following points to prevent hazardous situations:

- Do not use chains and accessories (accessories and parts) for anything other than their original purpose.
- Never perform additional processing on the chain.
 - Do not anneal the various parts of the chain.
 - Do not clean the chain with either acid or alkali, as they may cause cracking.
 - Do not electroplate the chain or its parts, as it may cause cracking due to hydrogen embrittlement.
 - Do not weld the chain, as the heat may cause cracking or a reduction in strength.
 - When heating or cutting the chain with a torch, remove the links immediately adjacent and do not use them again.
- When there is need to replace a lost or damaged portion of a chain, always replace the whole chain with a new product rather than replacing only the lost or damaged portion.
- When using a chain on suspension equipment, establish a safety perimeter and strictly prevent entry to the area directly below the suspended object.
- Always employ hazard protection devices for the chain and sprocket (safety cover, etc.).
- **If a substance that can cause embrittlement cracking (acid, strong alkali, battery fluid, etc.) adheres to the chain, stop using the chain immediately and replace it with a new one.**

During installation, removal, maintenance inspection and lubrication of the chain:

- Perform the operation according to the instruction manual.
- Always turn off the power switch to the device and make sure that it cannot be turned on accidentally.
- Anchor the chain and parts so that they cannot move freely.
- Perform cutting and connecting procedures properly using a press or other special tool.
- Wear clothing and employ protective devices that are appropriate to the job (safety glasses, gloves, safety footwear, etc.).
- Only allow experienced personnel to perform chain replacement procedures.
- A fail-safe back-up system is suggested whenever using a lifting Chain to safely support the load in the event of a chain failure.

CAUTION

Respect the following points to prevent hazardous situations:

- Only handle the chain after thoroughly understanding its structure and specifications.
- When installing a chain, inspect it in advance to ensure that it has not been damaged in transport.
- Be sure to perform regular maintenance inspections on the chain and sprocket.
- Minimum tensile strength refers to the failure point when the corresponding load is applied to the chain once and does not refer to the allowable operational load.



POWER TRANSMISSION

ONE MOTTO AND A SINGLE GOAL:
MAXIMISE LIFESPAN AND LIMIT MAINTENANCE



EXPERTISE

Products researched and designed for professional use that meet or exceed industry standards



QUALITY

Materials coming from the best steel mills manufactured in advanced thermal treatment facilities



INNOVATION

Specific manufacturing processes that surpass minimum established standards (ANSI)



CROMSON

Expertise • Quality • Innovation

Transmission chains built with solid rollers that can withstand the effects of workloads

Pre-lubricated and pre-stretched to reduce the breaking-in period to a minimum

Created to meet all ANSI standards with regards to strength and reliability



POWER TRANSMISSION

Expertise • Quality • Innovation

cromson.com



Transmission chain

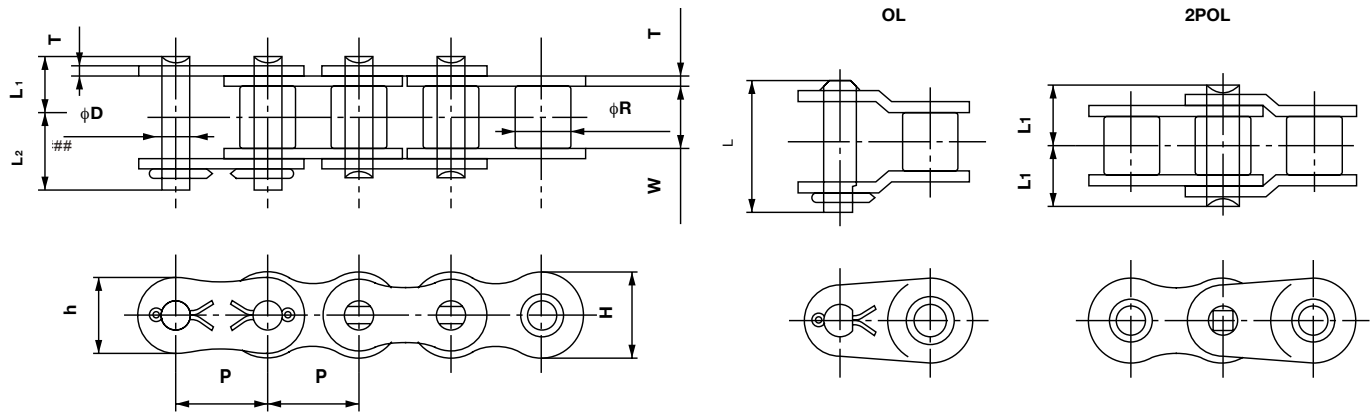

Chain Number	Pitch P	Roller Diameter R	Inner Width of Inner Link W	Plates Thickness			Diameter D	Axe					ANSI standard Minimum Tensile strength (lb)	Approx. weight (lb/pi)
				T Width	H Width	h Pins		Length L1 + L2	Length L1	Length L2	Offset Pin Length L			
Single strand														
35RBCROM	0,375	* 0,200	0,188	0,049	0,354	0,307	0,141	0,500	0,230	0,270	0,531	1 950	0,22	
40RBCROM	0,500	0,312	0,313	0,059	0,472	0,409	0,156	0,717	0,325	0,392	0,709	3 120	0,43	
50RBCROM	0,625	0,400	0,375	0,079	0,591	0,512	0,200	0,874	0,406	0,469	0,886	4 880	0,70	
60RBCROM	0,750	0,469	0,500	0,094	0,713	0,614	0,235	1 087	0,506	0,581	1 110	7 030	1,03	
80RBCROM	1 000	0,625	0,625	0,126	0,949	0,819	0,313	1 398	0,640	0,758	1 417	12 500	1,78	
100RBCROM	1 250	0,750	0,750	0,157	1 185	1 024	0,376	1 677	0,778	0,900	1 748	19 530	2,67	
120RBCROM	1 500	0,875	1 000	0,189	1 425	1 228	0,437	2 118	0,980	1 138	2 197	28 120	3,97	
140RBCROM	1 752	1 000	1 000	0,220	1 661	1 433	0,500	2 307	1 059	1 248	2 343	38 280	5,02	
Double strand														
C2060HRBCROM	1 500	0,469	0,500	0,126	0,677	-	0,235	1 224	0,573	0,652	-	7 030	1,01	
C2080HRBCROM	2 000	0,625	0,625	0,157	0,906	-	0,313	1 543	0,720	0,823	-	12 500	1,61	

* Means that the chain of dimension 35 is without rolls. The indicated dimension concerns the diameter of the bushing.

Standard roller chain

Cromson chains are carried by the unit in inventory.
 One unit consists of a 10-foot chain with a connecting link.
 If you wish to separate the chain in more than 2 sections or want to link several chains together, you can buy the necessary connecting links separately.

Cromson chain nomenclature

Part Number:

100RBCROM

CROMSON

Corresponds to the chain number
 35, 40, 50, 60, 80, 100, 120, 140,
 C2060, C2080

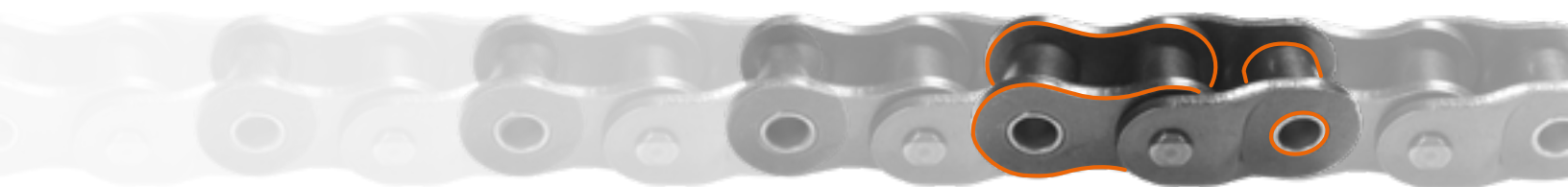

LUBRICATION OF THE CROMSON ROLLER CHAIN:



- All Cromson roller chains are pre-lubricated with a special high-quality lubricant.
- The lubrication was done to perfectly penetrate all chain pieces especially in critical areas where the rivet and bushing surfaces are used under a full load.
- A predefined schedule of roller chains lubrication is essential for optimal performance and maximum useful lifespan.
- Make the environmental choice by **using chain lubricant Vega 908**. Its strong penetrating power allows for a better and more uniform distribution of lubricant all the way to the center of the axes of the links.



Ask one of our Cromson specialists about our Molydal exclusivity



POWER TRANSMISSION

Expertise • Quality • Innovation

cromson.com

Standard roller chain - single strand

The power transmission chains respect ANSI B29.100 standards as well as ISO 606 standards (short pitch).



Part number	Model	Offset link	Connecting link
<i>35RBCROM</i>	35-1 RIV	<i>35OLCROM</i>	<i>35CLCROM</i>
<i>40RBCROM</i>	40-1 RIV	<i>40OLCROM</i>	<i>40CLCROM</i>
<i>50RBCROM</i>	50-1 RIV	<i>50OLCROM</i>	<i>50CLCROM</i>
<i>60RBCROM</i>	60-1 RIV	<i>60OLCROM</i>	<i>60CLCROM</i>
<i>80RBCROM</i>	80-1 RIV	<i>80OLCROM</i>	<i>80CLCROM</i>
<i>100RBCROM</i>	100-1 RIV	<i>100OLCROM</i>	<i>100CLCROM</i>
<i>120RBCROM</i>	120-1 RIV	<i>120OLCROM</i>	<i>120CLCROM</i>
<i>140RBCROM</i>	140-1 RIV	<i>140OLCROM</i>	<i>140CLCROM</i>



Connecting link



Offset link

Standard roller chain - single strand, double pitch

Part number	Model	Offset link	Connecting link
<i>C2060HRBCROM</i>	C2060H RIV	<i>C2060HOLCROM</i>	<i>C2060HCLCROM</i>
<i>C2080HRBCROM</i>	C2080H RIV	<i>C2080HOLCROM</i>	<i>C2080HCLCROM</i>



CROMSON sprockets Ready to use!



Over 450 sprocket models available

NO. 25 to 140 - Type A & B

NO. 2052 to 2080 - Type A & B

Looking for a sprocket for a specific application that isn't currently offered by Cromson?

Talk to one of our experts to find the right solution for you!



Our customers come from many different industries. The Cromson catalogue sprocket offering consists of the top 160 models used across several combined industries.

Quality and performance are key issues when it comes to your machine repair or maintenance. Each Cromson sprocket is induction-hardened, allowing for a maximum useful lifespan and consistent quality. This complements our chain offering and makes an ideal combination for your production needs.



NO. 35 - 3/8" Pitch - finished bore sprocket



Part number	Pattern	Length across the bore	Bore	Style	Pitch	Chain size	#Teeth
CRO35B10FF	35B10FF	.750"	3/8"	B	3/8	35	10
CRO35B10FH	35B10FH	.750"	1/2"	B	3/8	35	10
CRO35B10FJ	35B10FJ	.750"	5/8"	B	3/8	35	10
CRO35B11FJ	35B11FJ	.750"	5/8"	B	3/8	35	11
CRO35B11FL	35B11FL	.750"	3/4"	B	3/8	35	11
CRO35B12FH	35B12FH	.750"	1/2"	B	3/8	35	12
CRO35B12FJ	35B12FJ	.750"	5/8"	B	3/8	35	12
CRO35B12FL	35B12FL	.750"	3/4"	B	3/8	35	12
CRO35B12SS	35B12SS	.750"	1/2"	B	3/8	35	12
CRO35B13FJ	35B13FJ	.750"	5/8"	B	3/8	35	13
CRO35B13FL	35B13FL	.750"	3/4"	B	3/8	35	13
CRO35B14FH	35B14FH	.750"	1/2"	B	3/8	35	14
CRO35B14FJ	35B14FJ	.750"	5/8"	B	3/8	35	14
CRO35B14FL	35B14FL	.750"	3/4"	B	3/8	35	14
CRO35B15F-1	35B15F-1	.750"	1"	B	3/8	35	15
CRO35B15FH	35B15FH	.750"	1/2"	B	3/8	35	15
CRO35B15FJ	35B15FJ	.750"	5/8"	B	3/8	35	15
CRO35B15FL	35B15FL	.750"	3/4"	B	3/8	35	15
CRO35B16FJ	35B16FJ	.750"	5/8"	B	3/8	35	16
CRO35B16FL	35B16FL	.750"	3/4"	B	3/8	35	16
CRO35B18F-1	35B18F-1	.750"	1"	B	3/8	35	18
CRO35B18FL	35B18FL	.750"	3/4"	B	3/8	35	18
CRO35B20F-1	35B20F-1	.750"	1"	B	3/8	35	20
CRO35B20FJ	35B20FJ	.750"	5/8"	B	3/8	35	20
CRO35B20FL	35B20FL	.750"	3/4"	B	3/8	35	20
CRO35B21F-1	35B21F-1	.750"	1"	B	3/8	35	21
CRO35B22F-1	35B22F-1	.750"	1"	B	3/8	35	22
CRO35B24FJ	35B24FJ	.875"	5/8"	B	3/8	35	24
CRO35B24FL	35B24FL	.875"	3/4"	B	3/8	35	24
CRO35B30F-1D	35B30F-1D	1.000"	1-1/4"	B	3/8	35	30
CRO35B30FJ	35B30FJ	1.000"	5/8"	B	3/8	35	30
CRO35B30FL	35B30FL	1.000"	3/4"	B	3/8	35	30
CRO35B32FJ	35B32FJ	1.000"	5/8"	B	3/8	35	32
CRO35B32FL	35B32FL	1.000"	3/4"	B	3/8	35	32
CRO35B40FJ	35B40FJ	1.000"	5/8"	B	3/8	35	40
CRO35B40FP	35B40FP	1.000"	7/8"	B	3/8	35	40
CRO35B45FL	35B45FL	1.000"	3/4"	B	3/8	35	45



NO. 40 & 41- 1/2" Pitch - finished bore sprocket

Part number	Pattern	Length across the bore	Bore	Style	Pitch	Chain size	#Teeth
CRO40B9FJ	40B9FJ	.875"	5/8"	B	1/2	40	9
CRO40B10FJ	40B10FJ	.875"	5/8"	B	1/2	40	10
CRO40B10FL	40B10FL	.875"	3/4"	B	1/2	40	10
CRO40B11FJ	40B11FJ	.875"	5/8"	B	1/2	40	11
CRO40B11FL	40B11FL	.875"	3/4"	B	1/2	40	11
CRO40B11FP	40B11FP	.875"	7/8"	B	1/2	40	11
CRO40B12F-1	40B12F-1	.875"	1"	B	1/2	40	12
CRO40B12FH	40B12FH	.875"	1/2"	B	1/2	40	12
CRO40B12FJ	40B12FJ	.875"	5/8"	B	1/2	40	12
CRO40B12FL	40B12FL	.875"	3/4"	B	1/2	40	12
CRO40B12FP	40B12FP	.875"	7/8"	B	1/2	40	13
CRO40B13F-1	40B13F-1	.875"	1"	B	1/2	40	13
CRO40B13FH	40B13FH	.875"	1/2"	B	1/2	40	13
CRO40B13FJ	40B13FJ	.875"	5/8"	B	1/2	40	13
CRO40B13FL	40B13FL	.875"	3/4"	B	1/2	40	14
CRO40B14F-1	40B14F-1	.875"	1"	B	1/2	40	14
CRO40B14FH	40B14FH	.875"	1/2"	B	1/2	40	14
CRO40B14FJ	40B14FJ	.875"	5/8"	B	1/2	40	14
CRO40B14FL	40B14FL	.875"	3/4"	B	1/2	40	14
CRO40B15F-1	40B15F-1	.875"	1"	B	1/2	40	15
CRO40B15F-1D	40B15F-1D	.875"	1-1/4"	B	1/2	40	15
CRO40B15FL	40B15FL	.875"	3/4"	B	1/2	40	15
CRO40B15FP	40B15FP	.875"	7/8"	B	1/2	40	15
CRO40B16F-1	40B16F-1	.875"	1"	B	1/2	40	16
CRO40B16F-1D	40B16F-1D	.875"	1-1/4"	B	1/2	40	16
CRO40B16FJ	40B16FJ	.875"	5/8"	B	1/2	40	16
CRO40B16FL	40B16FL	.875"	3/4"	B	1/2	40	16
CRO40B17F-1	40B17F-1	1.000"	1"	B	1/2	40	17
CRO40B17FL	40B17FL	1.000"	3/4"	B	1/2	40	17
CRO40B18F-1	40B18F-1	1.000"	1"	B	1/2	40	18
CRO40B18F-1D	40B18F-1D	1.000"	1-1/4"	B	1/2	40	18
CRO40B18FJ	40B18FJ	1.000"	5/8"	B	1/2	40	18
CRO40B18FL	40B18FL	1.000"	3/4"	B	1/2	40	18
CRO40B19F-1	40B19F-1	1.000"	1"	B	1/2	40	19
CRO40B19FL	40B19FL	1.000"	3/4"	B	1/2	40	19
CRO40B20F-1	40B20F-1	1.000"	1"	B	1/2	40	20
CRO40B20FJ	40B20FJ	1.000"	5/8"	B	1/2	40	20
CRO40B20FL	40B20FL	1.000"	3/4"	B	1/2	40	20
CRO40B20FP	40B20FP	1.000"	7/8"	B	1/2	40	20
CRO40B21F-1	40B21F-1	1.000"	1"	B	1/2	40	21
CRO40B21FL	40B21FL	1.000"	3/4"	B	1/2	40	21

Part number	Pattern	Length across the bore	Bore	Style	Pitch	Chain size	#Teeth
CRO40B22F-1	40B22F-1	1.000"	1"	B	1/2	40	22
CRO40B22FL	40B22FL	1.000"	3/4"	B	1/2	40	22
CRO40B24F-1	40B24F-1	1.000"	1"	B	1/2	40	24
CRO40B24FJ	40B24FJ	1.000"	5/8"	B	1/2	40	24
CRO40B24FL	40B24FL	1.000"	3/4"	B	1/2	40	24
CRO40B25F-1	40B25F-1	1.000"	1"	B	1/2	40	25
CRO40B26F-1	40B26F-1	1.000"	1"	B	1/2	40	26
CRO40B28F-1	40B28F-1	1.000"	1"	B	1/2	40	28
CRO40B28FL	40B28FL	1.000"	3/4"	B	1/2	40	28
CRO40B30F-1	40B30F-1	1.000"	1"	B	1/2	40	30
CRO40B30FJ	40B30FJ	1.000"	5/8"	B	1/2	40	30
CRO40B32F-1	40B32F-1	1.000"	1"	B	1/2	40	32
CRO40B34FL	40B34FL	1.000"	3/4"	B	1/2	40	34
CRO40B35F-1	40B35F-1	1.000"	1"	B	1/2	40	35
CRO40B36F-1	40B36F-1	1.000"	1"	B	1/2	40	36
CRO40B48FL	40B48FL	1.000"	3/4"	B	1/2	40	48
CRO40B80F-1	40B80F-1	1.125"	1"	B	1/2	40	80

NO. 50 - 5/8" Pitch – simple bore sprocket

Part number	Pattern	Length across the bore	Bore	Type	Pitch	Chain size	#Teeth
CRO50B12	50B12	1.000"	5/8"	B	5/8	50	12
CRO50B15	50B15	1.000"	5/8"	B	5/8	50	15
CRO50B16	50B16	1.000"	5/8"	B	5/8	50	16
CRO50B18	50B18	1.000"	5/8"	B	5/8	50	18
CRO50B24	50B24	1.250"	3/4"	B	5/8	50	24
CRO50B30	50B30	1.250"	3/4"	B	5/8	50	30

Type A also available in several models. Talk to your Cromson specialist today!





NO. 50 - 5/8" Pitch - finished bore sprocket

Part number	Pattern	Length across the bore	Bore	Type	Pitch	Chain size	#Teeth
CRO50B9FL	50B9FL	1.000"	3/4"	A	5/8	50	9
CRO50B10F-1	50B10F-1	1.000"	1"	B	5/8	50	10
CRO50B10FL	50B10FL	1.000"	3/4"	B	5/8	50	10
CRO50B11F-1	50B11F-1	1.000"	1"	B	5/8	50	11
CRO50B12F-1	50B12F-1	1.000"	1"	B	5/8	50	12
CRO50B12F-1B	50B12F-1B	1.000"	1-1/8"	B	5/8	50	12
CRO50B12F-1D	50B12F-1D	1.000"	1-1/4"	B	5/8	50	12
CRO50B12FL	50B12FL	1.000"	3/4"	B	5/8	50	12
CRO50B13F-1	50B13F-1	1.000"	1"	B	5/8	50	13
CRO50B13F-1D	50B13F-1D	1.000"	1-1/4"	B	5/8	50	13
CRO50B13FL	50B13FL	1.000"	3/4"	B	5/8	50	13
CRO50B14F-1	50B14F-1	1.000"	1"	B	5/8	50	14
CRO50B14F-1D	50B14F-1D	1.000"	1-1/4"	B	5/8	50	14
CRO50B15F-1	50B15F-1	1.000"	1"	B	5/8	50	15
CRO50B15F-1B	50B15F-1B	1.000"	1-1/8"	B	5/8	50	15
CRO50B15F-1D	50B15F-1D	1.000"	1-1/4"	B	5/8	50	15
CRO50B15FL	50B15FL	1.000"	3/4"	B	5/8	50	15
CRO50B16F-1	50B16F-1	1.000"	1"	B	5/8	50	16
CRO50B16F-1D	50B16F-1D	1.000"	1-1/4"	B	5/8	50	16
CRO50B16F-1F	50B16F-1F	1.000"	1-3/8"	B	5/8	50	16
CRO50B16F-1H	50B16F-1H	1.000"	1-1/2"	B	5/8	50	16
CRO50B17F-1	50B17F-1	1.000"	1"	B	5/8	50	17
CRO50B17F-1D	50B17F-1D	1.000"	1-1/4"	B	5/8	50	17
CRO50B18F-1	50B18F-1	1.000"	1"	B	5/8	50	18
CRO50B18F-1D	50B18F-1D	1.000"	1-1/4"	B	5/8	50	18
CRO50B18F-1G	50B18F-1G	1.000"	1-7/16"	B	5/8	50	18
CRO50B18FL	50B18FL	1.125"	3/4"	B	5/8	50	18
CRO50B19F-1	50B19F-1	1.125"	1"	B	5/8	50	19
CRO50B20F-1	50B20F-1	1.125"	1"	B	5/8	50	20
CRO50B20F-1D	50B20F-1D	1.125"	1-1/4"	B	5/8	50	20
CRO50B20F-1H	50B20F-1H	1.125"	1-1/2"	B	5/8	50	20
CRO50B21F-1	50B21F-1	1.250"	1"	B	5/8	50	21
CRO50B22F-1	50B22F-1	1.250"	1"	B	5/8	50	22
CRO50B23F-1D	50B23F-1D	1.250"	1-1/4"	B	5/8	50	23
CRO50B24F-1	50B24F-1	1.250"	1"	B	5/8	50	24
CRO50B26F-1	50B26F-1	1.250"	1"	B	5/8	50	26
CRO50B28F-1	50B28F-1	1.250"	1"	B	5/8	50	28
CRO50B32F-1D	50B32F-1D	1.375"	1-1/4"	B	5/8	50	32
CRO50B40F-1	50B40F-1	1.375"	1"	B	5/8	50	40
CRO50B40F-1D	50B40F-1D	1.375"	1-1/4"	B	5/8	50	40



NO. 60 - 3/4" Pitch - finished bore sprocket

Part number	Pattern	Length across the bore	Bore	Type	Pitch	Chain size	#Teeth
CRO60B9F-1	60B9F-1	1.250"	1"	B	3/4	60	9
CRO60B10F-1	60B10F-1	1.250"	1"	B	3/4	60	10
CRO60B10FL	60B10FL	1.250"	3/4"	B	3/4	60	10
CRO60B11F-1	60B11F-1	1.250"	1"	B	3/4	60	11
CRO60B11F-1D	60B11F-1D	1.250"	1-1/4"	B	3/4	60	11
CRO60B12F-1	60B12F-1	1.250"	1"	B	3/4	60	12
CRO60B12F-1B	60B12F-1B	1.250"	1-1/8"	B	3/4	60	12
CRO60B12F-1C	60B12F-1C	1.250"	1-3/16"	B	3/4	60	12
CRO60B12F-1D	60B12F-1D	1.250"	1-1/4"	B	3/4	60	12
CRO60B12FL	60B12FL	1.250"	3/4"	B	3/4	60	12
CRO60B13F-1	60B13F-1	1.250"	1"	B	3/4	60	13
CRO60B13F-1D	60B13F-1D	1.250"	1-1/4"	B	3/4	60	13
CRO60B13F-1H	60B13F-1H	1.250"	1-1/2"	B	3/4	60	13
CRO60B14F-1	60B14F-1	1.250"	1"	B	3/4	60	14
CRO60B14F-1D	60B14F-1D	1.250"	1-1/4"	B	3/4	60	14
CRO60B14F-1G	60B14F-1G	1.250"	1-7/16"	B	3/4	60	14
CRO60B14F-1H	60B14F-1H	1.250"	1-1/2"	B	3/4	60	14
CRO60B15F-1	60B15F-1	1.250"	1"	B	3/4	60	15
CRO60B15F-1B	60B15F-1B	1.250"	1-1/8"	B	3/4	60	15
CRO60B15F-1C	60B15F-1C	1.250"	1-3/16"	B	3/4	60	15
CRO60B15F-1D	60B15F-1D	1.250"	1-1/4"	B	3/4	60	15
CRO60B15F-1F	60B15F-1F	1.250"	1-3/8"	B	3/4	60	15
CRO60B15F-1H	60B15F-1H	1.250"	1-1/2"	B	3/4	60	15
CRO60B16F-1	60B16F-1	1.250"	1"	B	3/4	60	16
CRO60B16F-1F	60B16F-1F	1.250"	1-3/8"	B	3/4	60	16
CRO60B16F-1H	60B16F-1H	1.250"	1-1/2"	B	3/4	60	16
CRO60B16F-1L	60B16F-1L	1.250"	1-3/4"	B	3/4	60	16
CRO60B16F-1R	60B16F-1R	1.250"	1-15/16"	B	3/4	60	16
CRO60B17F-1	60B17F-1	1.250"	1"	B	3/4	60	17
CRO60B17F-1D	60B17F-1D	1.250"	1-1/4"	B	3/4	60	17
CRO60B17F-1H	60B17F-1H	1.250"	1-1/2"	B	3/4	60	17
CRO60B18F-1	60B18F-1	1.250"	1"	B	3/4	60	18
CRO60B18F-1D	60B18F-1D	1.250"	1-1/4"	B	3/4	60	18
CRO60B18F-1F	60B18F-1F	1.250"	1-3/8"	B	3/4	60	18
CRO60B18F-1G	60B18F-1G	1.250"	1-7/16"	B	3/4	60	18
CRO60B18F-1H	60B18F-1H	1.250"	1-1/2"	B	3/4	60	18
CRO60B18F-1L	60B18F-1L	1.250"	1-3/4"	B	3/4	60	18
CRO60B18F-1R	60B18F-1R	1.250"	1-15/16"	B	3/4	60	18
CRO60B19F-1G	60B19F-1G	1.250"	1-7/16"	B	3/4	60	19
CRO60B20F-1	60B20F-1	1.250"	1"	B	3/4	60	20
CRO60B20F-1B	60B20F-1B	1.250"	1-1/8"	B	3/4	60	20
CRO60B20F-1D	60B20F-1D	1.250"	1-1/4"	B	3/4	60	20
CRO60B20F-1H	60B20F-1H	1.250"	1-1/2"	B	3/4	60	20
CRO60B21F-1	60B21F-1	1.250"	1"	B	3/4	60	21
CRO60B21F-1D	60B21F-1D	1.250"	1-1/4"	B	3/4	60	21
CRO60B22F-1D	60B22F-1D	1.250"	1-1/4"	B	3/4	60	22
CRO60B23F-1D	60B23F-1D	1.500"	1-1/4"	B	3/4	60	23
CRO60B24F-1	60B24F-1	1.500"	1"	B	3/4	60	24
CRO60B24F-1D	60B24F-1D	1.500"	1-1/4"	B	3/4	60	24
CRO60B24F-1G	60B24F-1G	1.500"	1-7/16"	B	3/4	60	24



NO. 80 - 1" Pitch - simple bore sprocket

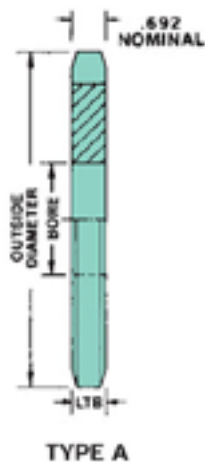

Part number	Pattern	Length across the bore	Bore	Type	Pitch	Chain size	#Teeth
CRO80B9	80B9	1.563"	1"	B	1	80	9
CRO80B10	80B10	1.563"	1"	B	1	80	10
CRO80B12	80B12	1.563"	1"	B	1	80	12
CRO80B13	80B13	1.563"	1"	B	1	80	13
CRO80B14	80B14	1.563"	1"	B	1	80	14
CRO80B15	80B15	1.563"	1"	B	1	80	15
CRO80B16	80B16	1.875"	1"	B	1	80	16
CRO80B17	80B17	1.875"	1"	B	1	80	17
CRO80B18	80B18	1.875"	1"	B	1	80	18
CRO80B20	80B20	1.875"	1"	B	1	80	20
CRO80B21	80B21	1.875"	1"	B	1	80	21
CRO80B22	80B22	1.875"	1"	B	1	80	22
CRO80B24	80B24	1.875"	1"	B	1	80	24

Type A also available in several models. Talk to your Cromson specialist today!



NO. 80 - 1" Pitch - finished bore sprocket

Part number	Pattern	Length across the bore	Bore	Type	Pitch	Chain size	#Teeth
CRO80B10F-1	80B10F-1	1.563"	1"	B	1	80	10
CRO80B10F-1H	80B10F-1H	1.563"	1-1/2"	B	1	80	10
CRO80B12F-1	80B12F-1	1.563"	1"	B	1	80	12
CRO80B12F-1D	80B12F-1D	1.563"	1-1/4"	B	1	80	12
CRO80B12F-1H	80B12F-1H	1.563"	1-1/2"	B	1	80	12
CRO80B14F-1	80B14F-1	1.563"	1"	B	1	80	14
CRO80B14F-1H	80B14F-1H	1.563"	1-1/2"	B	1	80	14
CRO80B18F-1D	80B18F-1D	1.875"	1-1/4"	B	1	80	18
CRO80B18F-1H	80B18F-1H	1.875"	1-1/2"	B	1	80	18
CRO80B20F-1H	80B20F-1H	1.875"	1-1/2"	B	1	80	20

Control hazards to reduce adverse health effects
and limit damage to the facility
It is important to respect procedures!
Whenever you face an emergency, stay calm
and follow the established procedures

EMERGENCY NUMBERS CANADA:

9-1-1

To report a life-threatening emergency

8-1-1

To report a non-life-threatening incident

When calling these numbers, be prepared to provide the following information:

Type of emergency

Address of the emergency

Phone number

Type of required assistance

Treatments previously administered

The above information comes from the official CCHSCT Canada website.
Please refer to the regulations for more information.

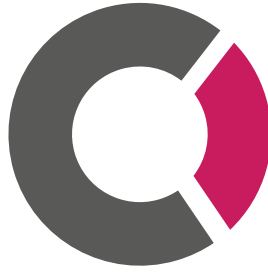

SAFETY - SANITARY

ONE MOTTO AND A SINGLE GOAL:
TO MAKE AVAILABLE SIMPLE AND EFFECTIVE SOLUTIONS
TO PREVENT EVERYDAY ACCIDENTS AND TO PROTECT THOSE AROUND YOU



EXPERTISE

Products researched and designed for professional use that meet or exceed industry standards



QUALITY

A wide range of safety products offering the best value for the money



INNOVATION

Adaptable protection to ensure your safety and the safety of others

CNESST First aid kit



For car

Part Number CR8000

25 employees and less

Part Number CR8025



51 employees and less

Part Number CR8051

16 to 200 employees

Part Number CR8016



**NEW FIRST AID KITS
APPROVED BY 2021 CNESST
STANDARDS**

Non-contractual photo.

First aid kits

ONTARIO SCH Regulation



1-5 workers
Plastic box

Part Number CR8002

6-15 workers
Plastic box

Part Number CR8003

16-200 workers
Plastic box

Part Number CR8004



Ontario Regulation First Aid Kits

Description	1 - 5 WORKERS	6 - 15 WORKERS	16 - 200 WORKERS
Aluminum Splint - 24" (60.96 cm)		1	
Assorted Safety pins – 4 large / 4 medium / 4 small	1	1	2
Compress - 4" (10 cm)	2	4	6
First Aid Pocket Guide	1	1	1
Gauze Bandage – 1" x 5VG (2.5 cm x 4.5 m)			12
Gauze Bandage – 2" x 5VG (5 cm x 4.5 cm)	2	4	8
Gauze Bandage - 4" x 5VG (10 cm x 4.5 cm)		4	8
Gauze Pad - 3" x 3" (7.5 cm x 7.5 cm)	4	12	48
Hospital Tape - 1" x 5VG (2.5 cm x 4.5 m)			2
Plastic Emesis Basin			1
Plastic Strips – 3/4" x 3" (1.9 cm x 7.5 cm)	12	24	48
Splint Padding (1/pack)		2	2
Splint Set (6/pack)			1
Stainless steel Wash Basin			1
Triangular Bandage - 40" (1 m)	1	6	12

Block public access to dangerous areas
Designate an obstacle
Define a bypass route

The four fundamental principles



ADAPTATION

- ▲ To public roads, speed and traffic density
- ▲ Type and scope of work

COHERENCE

- ▲ Between road signs and permanent signage
- ▲ Between the information provided by the equipment and that given by the flagman

CREDIBILITY

- ▲ Bypass routes must be justified by the reality and nature of the construction site
- ▲ Messages must be communicated to all drivers

VISIBILITY

- ▲ Signaling devices must be clean, in good condition and properly installed
- ▲ Signage sizes and colours must be in accordance with industry standards

*All information is given only as a reference
 Thank you for taking note of the established regulations before using traffic cones
 Source: Transports Québec / APSAM - road works signage guide*



Traffic cones

Body is made of durable PVC
Black rubber base

Use in various weather conditions (Temperature Range: -20°C to +50°C)

High visibility safety orange

Thermoformed molding

Stackable

Part Number	Height	Base	Collar	Weight (lb)
CR8100	18" - 450 mm	10-5/8" x 10-5/8"	-	3
CR8101	18" - 450 mm	10-5/8" x 10-5/8"	(1) 4"	3
CR8102	18" - 450 mm	10-5/8" x 10-5/8"	(1) 6"	3
CR8103	28" - 700 mm	14" x 14"	-	7
CR8104	28" - 700 mm	14" x 14"	(1) 4"	7
CR8105	28" - 700 mm	14" x 14"	(1) 4" & (1) 6"	7



* Item may vary slightly from image

MOHAN HAND PROTECTION

The new Mohan range specializes in hand protection for professional use and offers products that are:

- **Rugged**, with high quality materials resistant to chemical products and tears
- **Comfortable** as well as offering greater dexterity
- **Safe** protection for your hands during maintenance operations, handling, production...

This expanding range of product offers:

- Blue Nitrile **gloves** 4.5mil
- Black Nitrile **gloves** 6 mil
- Blue Nitrile **gloves** 8 mil
- Heavy-duty degreaser **wipes**



DID YOU KNOW ?

All white tigers around the world today have the same ancestor: Mohan. He was the first white tiger found in India in 1951. From the Panthera tigris endangered species, we recognize them by their white coat with black or brown stripes. Its scarcity makes it a precious tiger, stronger and bigger than others.

Like the tiger, your hands are precious, and you need to protect them. You won't look at your paws the same way!





Application: maintenance, manufacturing, material handling, food handling, automobile, etc.
Textured for excellent grip
Resistant to chemicals and tears
Store in a cool, dry place
Avoid excessive heat (40°C, 104°F)



Strong blue nitrile gloves - 4.5 mil

Nitrile 4.5 mil

Powder-free and non-sterile

Packaging 100 gloves

Part number	Size
CR8300S	S - 85 mm
CR8300M	M - 95 mm
CR8300L	L - 105 mm
CR8300XL	XL - 115 mm





Application: maintenance, manufacturing, material handling, food handling, automobile, etc.
Textured for excellent grip
Resistant to chemicals and tears
Store in a cool, dry place
Avoid excessive heat (40°C, 104°F)



Strong black nitrile gloves - 6 mil

Nitrile - 6 mil

Powder-Free and non-sterile

Packaging: 100 gloves

Part Number	Size
CR8200S	S - 85 mm
CR8200M	M - 95 mm
CR8200L	L - 105 mm
CR8200XL	XL - 115 mm
CR8200XXL	XXL - 125 mm

Strong blue Nitrile gloves - 8 mil

Nitrile

Powder-Free and non-sterile

Packaging: 50 gloves



Part Number	Size
CR8250M	M - 95 mm
CR8250L	L - 105 mm
CR8250XL	XL - 115 mm
CR8250XXL	XXL - 125 mm





Thick double-faced wipes:
 - textured blue side - gentle abrasive very effective for heavy stains
 - smooth white side - soft for finishing cleaning

Clean and degreasing moist wipes

Tested under dermatological control
 In accordance with the Cosmetic Regulations (EU)no 1223/2009
 In accordance with Detergent Regulation (EU) n ° 648/2004
 Highly efficient cleaning wipes for hands, tools and machine parts

Type: Double sided rough / soft
 Colour: Blue / white
 Grammage: 45g / m² - tolerance ± 12%
 pH: 5.0 ± 0.5
 Density: 1.00 ± 0.05

Scent: Citrus
 Storage temperature: 5 °C <T <40 °C
 Efficacy: 12 months

Effective cleaning of hands, surfaces, tools, machines and objects
Can be used without water, without soap, without rinsing and residue-free
Convenient packaging, ready to use
Non irritating formula
Biodegradable



Part number	Qty per container
CR2830	40
CR2880	80

Contactless multi-function tool

Weight: 7 gm - Length: 10 cm

Perform daily gestures without touching potentially infected surfaces and objects.

With this tool you'll discover no less than 11 possible functions: lift, carry, pull, push, raise, lower, press or make hand-free contact ...

Tip: Hang it on your keychain!

	Part Number
Contactless multi-function tool	CR3200
Pack of 5 contactless multi-function tools	CR3205

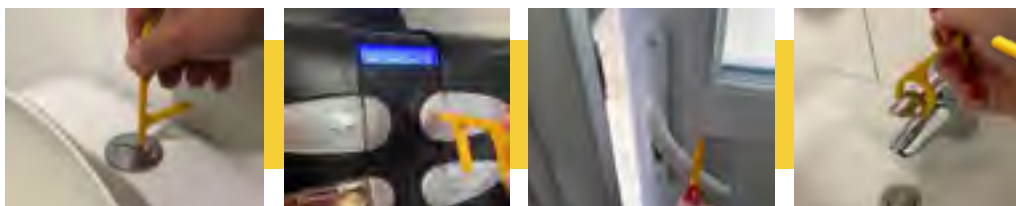



BILLY-W goatskin driver's glove with Thinsulate™ winter lining



Take your favourite BILLY goatskin glove and add a Thinsulate™ winter lining and you have BILLY-W to conduct your daily outdoor activities. Keeps you warm without compromising on dexterity or flexibility.

- Winter protection up to -10 °C / 14°F
- Thinsulate™ winter lining - High-tensile strength
- Abrasion-resistant



S	M	L	XL	XXL
CR8429	CR8425	CR8426	CR8427	CR8428

Cromson gloves are made of premium cow grain leather or goatskin with extra materials such as Kevlar®, Spandex, Thinsulate™ lining to ensure that your employees have the right size for their needs.

Explore our range of gloves to find the PERFECT FIT that will reduce the potential of employee hand injuries.

Each glove has a colour code on the cuff to ensure that your employees have the right size for their needs.



X-SMALL
6



SMALL
7



MEDIUM
8



LARGE
9



XL
10



XXL
11



BILLY goatskin driver's glove

BILLY goatskin driver's gloves are your all-around working gloves. Excellent in an industrial work environment.

High-tensile strength - Abrasion-resistant - Durability

Use: general material handling, general maintenance, light welding , construction

S	M	L	XL	XXL
CR8404	CR8405	CR8406	CR8407	CR8408



GOAT goatskin driver's glove with Spandex back

Looking for flexibility but unwilling to compromise on safety? GOAT is an alternate option to BILLY. The spandex back offers more breathability and comfort in your day-to-day operations.

Firm grip - Durability - Flexibility - Breathability

Use: maintenance, general material handling, construction, forklifts trucking, automotive

XS	S	M	L	XL
CR8412	CR8413	CR8414	CR8415	CR8416





RAM goatskin driver's glove with impact-resistant protection

Need back-of-hand protection? RAM is definitely your pick. With a ANSI A5 Cut rating due to its Kevlar® lining, this product offers the best of both worlds while ensuring cut & impact resistance.

Impact resistant - High-tensile strength - Abrasion-resistant

Use: oils & gas , metal fabrication, construction sites, heavy lifting



S	M	L	XL	XXL
CR8417	CR8418	CR8419	CR8420	CR8421



BILLY-K goatskin driver's glove with a Kevlar® lining

Combine your BILLY with a Kevlar® lining and there you have your BILLY-K goatskin driver's glove. The Kevlar® lining's cut-resistant properties has our BILLY-K rated as ANSI level-A5 cut protection.

High-tensile strength - Abrasion-resistant

Use: manufacturing, metal fabrication, refineries, construction, forklift, trucking, maintenance



M	L	XL
CR8409	CR8410	CR8411





TORO cow grain leather glove with gauntlet safety cuff

TORO cow grain leather gloves were designed with a gauntlet safety cuff for general purpose uses.

Gauntlet safety cuff - Abrasion protection

Use: metalworking, grinding , light welding, material handling

M	L	XL
CR8401	CR8402	CR8403



OUTRIGGER goatskin driver's glove with HiViz fingertips

OUTRIGGERS are your typical BILLY gloves with high visibility fingertips and thumb. Keep your fingers visible at all times.

High visibility fingertips - Abrasion-resistant - Durability

Use: rigging, crane operators, sawmills, signal personnel

M	L	XL
CR8422	CR8423	CR8424



SANITARY

**KILLS
BACTERIA
& GERMS**

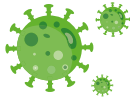

**HEAVY-DUTY HARD SURFACE CLEANER,
DEGREASER,
DISINFECTANT**

**70 % ALCOHOL
GEL HAND
SANITIZER**

**70% ALCOHOL
HARD SURFACE
CLEANER**



**Cromson meets today's disinfecting and sanitizing needs
for hard surfaces and hand hygiene.**



Made in Canada in a ready-to-use format



Quality ingredients approved by Health Canada



Fragrance-free, which allows daily use of the products without any exposure to unpleasant odours



Several sizes available to meet your daily needs



Designed for: factories, construction sites, vehicles, offices, home, computing equipment...

Gel hand sanitizer 70 % alcohol

Vitamin E-enriched solution to prevent skin dryness and the risks of dermatosis

Product made with premium food-grade alcohol, free of soap, detergent or solvent

Approved by Health Canada

Kills bacteria & germs

NPN 80105084

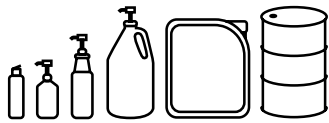

BENEFITS :

- Odourless antiseptic solution
- Residue-free
- Fast drying
- Moisturizing

Item	Container	Size	Box	Pallet
CR8310	Bottle	118mL	24	1800
CR8311	Bottle	500mL	12	216
CR8312	Bottle	946mL	12	216
CR8313	Jug	3,78L	4	72
CR8314	Jug	20L	1	24
CR8315	Barrel	208L	1	-



Accessory

Spout for 20L jug.

Item CR8316



Non-rinse, 70% alcohol hard surface cleaner



NO RINSE SOLUTION

Food alcohol product 70%

Ideal for items that are handled regularly

Perfect for daily cleaning of hard surfaces

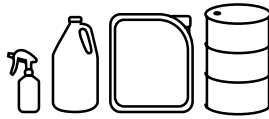

APPLICATIONS :

- Work benches
- Tables, desks, chairs
- Handles, valves, light switches
- Elevator buttons, keyboards and mouse
- Ramps, personal protective equipment
- Vending machines, point-of-sale terminals

Item	Container	Size	Box	Pallet
CR8304	Spray	500mL	12	216
CR8317	Spray	946mL	12	216
CR8305	Jug	3,78L	4	72
CR8306	Jug	20L	1	24
CR8318	Barrel	208L	1	-

No rinse solution

Slow evaporation to maximize contact time on your surface

Food grade alcohol

Odorless

Leaves no residue on your surface

Hard surface heavy-duty cleaner, degreaser & disinfectant

Perfect to clean and disinfect in one step

Quaternary ammonium-based product

Does not contain bleach or corrosive chemicals

Its odourless triple-action formula is recommended for industrial use

Removes the toughest grease, grime, stains and bacteria

DIN 02507617



APPLICATIONS :

- Floors, walls
- Counters
- Machinery, tools, equipment
- Plastic, ceramic, metal and other
- Work benches

Item	Container	Size	Box	Pallet
CR8301	Spray	946mL	12	216
CR8302	Jug	3,78L	4	72
CR8303	Jug	20L	1	24



Cleans thoroughly, kills germs and bacteria in a single operation

Removes grease, dirt, stains, dust, mold and more

No bleach or corrosive chemicals

Powerful degreaser, replaces strong solvent degreasers



**CUSTOMIZABLE
CROMSON
SANITARY STATION**

**Be the workplace health & safety leader
thanks to the Cromson sanitary station**

- **Sanitary standards met with contact-free gel**
- **Compartments for health & safety accessories
(gloves, masks, glasses, earplugs...)**
- **Suitable for any indoor or outdoor environment**

Customizable Cromson sanitary station

Provide a clean and healthy environment with this customizable and safe hand sanitizer



Cleanliness
Drip Collector

Security
Possibility of securing
it to the ground



Disinfects hands without contact
> Pedal mechanism



Robust design
> Made of steel



Possibility to install it
indoors or outdoors



Made in France



A bottle of hand sanitizer CR8312
of 946 ml **offered**



Several accessories to choose from
> **document holder with shelf,**
without shelf, trash bin.

Dimensions : 27.5 x 27.5 x 100 cm
Weight : 12,5 kg (without accessories)

Sanitary Station	Full	CR8350
	Alone	CR8351

**Create your customized disinfectant station by choosing the elements
that will suit your reality and workspace!**



**Document support
without shelf**

Left	CR8352
Right	CR8353



**Document support
with shelf**

Left	CR8354
Right	CR8355



**Cardboard
bin**

CR8356



SERVICES

ONE MOTTO AND A SINGLE GOAL:
HELP YOU INCREASE YOUR EFFICIENCY AND REDUCE YOUR COSTS



EXPERTISE

Specialists looking for solutions to improve the production environment of their customers (food, mining, manufacturing, etc.)



QUALITY

Customized solutions adapted to your environment to meet your needs



INNOVATION

Based on continuous quality improvement processes (Iso, Lean, Six Sigma)



Consumables management service (CMS)

NEVER RUN OUT OF CONSUMABLES AGAIN!

Why choose cabinets ?

- Cost saving
- Personalized inventory by department
- Consignment stock safely secured



Dimensions : 32" x 13" x 25"

Why rely on a Consumables Management Service (CMS)?

- Product access at all times
- Customized replenishment
- Elimination of re-ordering process
- Cost-effective inventory tracking

Custom foam creation

ORGANIZE YOUR WORK ENVIRONMENT AND INCREASE YOUR PRODUCTIVITY

Inspired by Kaizen and 5S methods, Cromson offers a customized foam creation service.

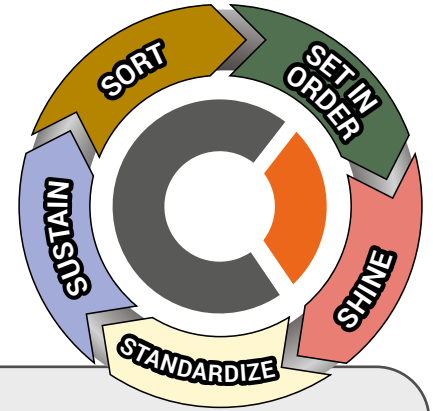

Benefits of the Cromson foam program

- Efficiency
- Employee satisfaction and empowerment
- Cost savings
- Accident prevention



Compatible avec : Toughsystem (DeWalt) - Packout - Milwaukee - Cabinets (Rousseau) - MakPac (Makita)



Food & beverage industry



Construction



Pits or quarries



Flexible packaging industry

Wear part optimisation

SMALL IMPROVEMENTS = SAVINGS

Ask yourself the right questions:

Do you have to constantly **change wearing parts** on your machines?

1

Discover our **analysis, improvement and machining program** for high volume **wearing parts**.

Are you **waiting for equipment parts** to resume your production?

2

This unique program is aimed at **ASSESSING and IMPROVING** your wearing parts in your production environment

MACHINE BENEFITS

- Quality of materials = Reduced machine downtime
- Just-in-time parts availability
- Custom manufacturing of parts

BENEFITS FOR PRODUCTION

- Up-to-date production schedule
- Consistency in the quality of the products you manufacture
- Decrease in budgets related to maintenance

For more information, please contact us at info@cromson.ca

From design to implementation

FROM DESIGN TO IMPLEMENTATION

Improve the quality of the wear parts of your machines
Minimize production downtime for maintenance purposes.



Turnkey service for the creation and improvement of wear parts
for your production line machinery

Supported by our experienced engineers and technicians

Each project is unique and customized

3 ÉTAPES SIMPLES

Design :

- Initial contact
- Project evaluation
- Mandate definition

Modeling :

- Product improvement
- 3D prototyping
- Project validation

Implementation :

- Production start-up
- Stock adjustment
- Just-in-time part supply



DID YOU KNOW THAT:

The cost of machine downtime and maintenance : up to 60% of the cost of goods produced

30% of the amounts invested in maintenance have no return

90% of maintenance tasks are corrective in nature, related to an emergency

The Cromson advantage

OUR MULTI-TALENTED TEAM MOBILIZES ALL NECESSARY COLLABORATORS TO SOLVE YOUR ENGINEERING PROBLEMS..

What sets us apart: customized processes - versatility to work with various materials - customized surface finish



PROCESSES USED

- Precision CNC machining
- Moulding
- Extrusion
- Laser and water jet cutting
- Bending
- Welded mechanical assemblies
- 3D printing



MATERIAL USED

- Aluminium
- Steel
- Structural steel
- Stainless steel
- Brass
- Titanium
- Nylon
- Other plastics (UHMW, Acetal...)



SURFACE FINISHING AND TREATMENT

- Anodizing
- Powder coating
- Laser engravings
- Chrome plating
- Nickel plating
- Heat treatment

To date, our achievements have enabled our customers to benefit from:

- Cost savings
- Productivity improvement
- Engineering consulting and optimized technical solution
- Flexibility of our specialized teams during the implementation of the project in the factory

Flexibility of the specialized teams

Do you operate non-stop, 7 days a week ?

Days, nights or even on weekends, our teams travel at agreed upon time with the customer to:

- Perform analyses during downtime
- Assist your maintenance teams during reassembly

Cost savings

MANDATE: Design and production of customized CAMS FOLLOWERS

Reverse engineering project on wear parts for a customer of the food industry

Alternative to wear parts that would normally be available from a single distributor

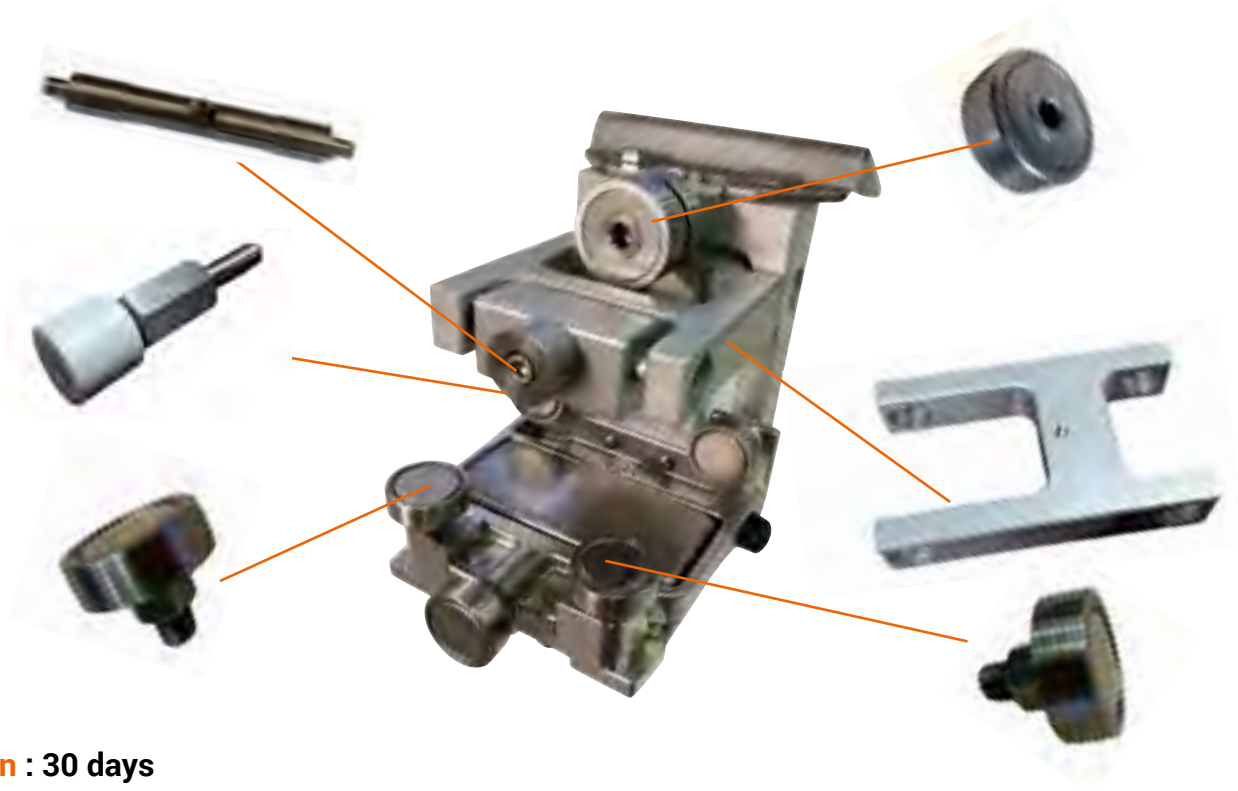

Design : 30 days

Production : 120 days

Result : 30% savings compared to the sole supplier of this product

Productivity improvement

MANDATE: Improvement of a wear part on a production module.

Study of food type machine bearings which demonstrated :

- low mechanical strength
- part replacement on a weekly basis

Review of the selection of materials that make up the wear part

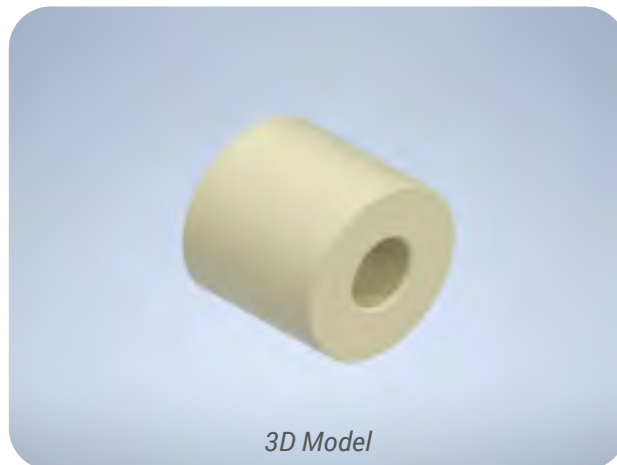

Duration of the study: 2 months

Replacement: 35 days (selection of the right polymer and brass alloy)

- Result:**
- A 2 month increase in the useful life of the part
 - Productivity improvement
 - Increased gaps between maintenance operations

Engineering consulting and optimization

MANDATE: Optimization of a mechanical part of a high pressure centrifugal pump.

In-depth analyses of mechanical problems that cause production delays or interruptions.

Improvement of the geometric tolerances for the mechanical part

Analysis by coordinate measuring machines (CMM)

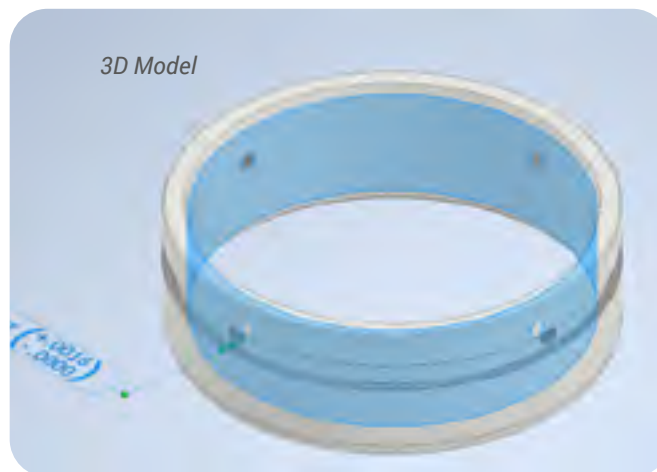

Duration of the study: 30 days

Implementation: 60 days

Result: Reduction in breakages and therefore a decrease in the allocated maintenance time of the centrifugal pump

1/2" drive extensions	p. 17
1/2" drive ratchet	p. 17
1/2" drive sockets	p. 18
1/2" drive sockets deep	p. 19
1/2" drive universal joint	p. 17
1/4" drive bit-holder screwdriver	p. 11
1/4" drive bit-holder socket	p. 11
1/4" drive extensions	p. 9
1/4" drive ratchet	p. 9
1/4" drive sockets	p. 10
1/4" drive universal joint	p. 9
3/8" drive extensions	p. 13
3/8" drive ratchet	p. 13
3/8" drive sockets	p. 14
3/8" drive sockets deep	p. 15
3/8" drive universal joint	p. 13
Abrasive rolls	p. 57
Abrasive rolls dispenser	p. 57
Adjustable wrenches	p. 26
Bars	p. 74
Cable ties	p. 73
Carbide burrs	p. 65
Chain hoists	p. 85
Clamps	p. 30
Cleaning wipes	p. 113
Coating removal discs	p. 53 - 55
Countersinks	p. 60
Cut-off wheels	p. 56
Cutting wheels	p. 51
Disc holders	p. 55
Drill bits HSS	p. 66 - 67
Drill bit sets HSS	68
First aid kits	p. 106 - 107
Flap discs	p. 50

Flashlights	p. 73
Folding table	p. 29 & 81
Gloves	p. 111
Grinding discs	p. 52
Grinding wheels	p. 53
Hammers	p. 31
Hand tool sets	p. 44 - 45 - 46 - 47
Hand trucks	p. 84
Hex key sets	p. 26
Knives and blades	p. 78 - 79
Lever hoists	p. 86
Measuring tapes	p. 40
Paint brushes	p. 72
Pliers	p. 34 - 35
Pliers locking	p. 37 - 38 - 39
Quick support rods	p. 30
Ratchet straps	p. 89
Screwdriver set	p. 20
Screwdrivers	p. 22 - 23
Screwdriver bit set	p. 11
Shovels	p. 75 - 76 - 77
Slings	p. 88
Step drills	p. 65
Storage boxes	p. 45 - 47
Surface conditioning Discs	p. 54
Taps HSS	p. 62 - 63 - 64
Tap sets HSS	p. 61
Tarps	p. 72
Traffic cones	p. 109
Trolleys	p. 87
Vises and jaws	p. 28 - 29 - 64
Wrenches and sets	p. 24 - 25
Wrench pouch	p. 25



CROMSON

Expertise • Quality • Innovation

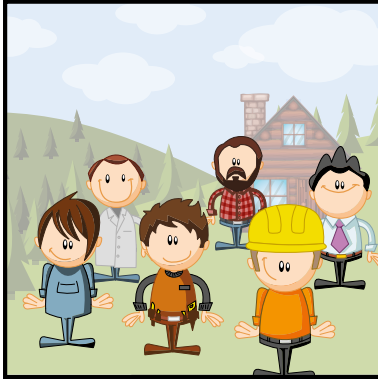

CROMSON is a passionate and devoted team with heart and commitment.

1

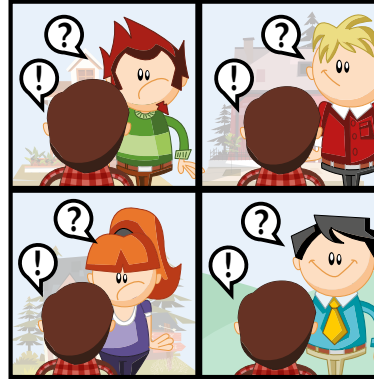

Openly receptive, motivated and versatile, they can adapt to anything the client wants.

2

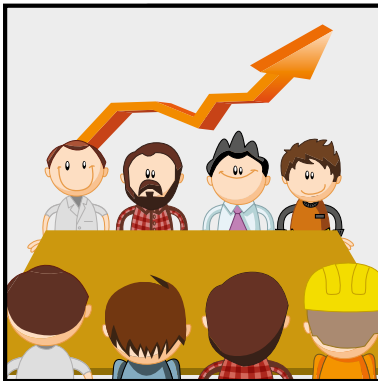

2013
The results speak for themselves, the market study shows there is a real demand. A new brand is created!

3



2016
Time for the launch! CROMSON, a robust and solid brand, is launched on the market. Its slogan: "Expertise, Quality, Innovation".

4

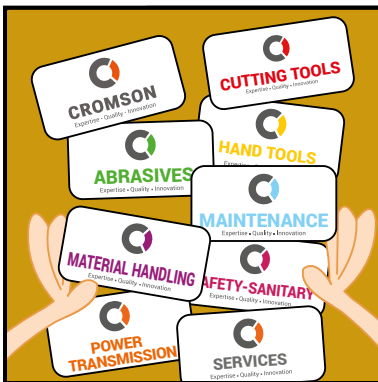

The brand grows and now offers different types of products: Cutting tools, Hand tools, Abrasives, Safety, Material Handling, Maintenance...

5

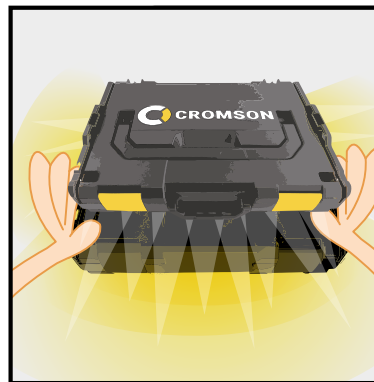

To ensure a high-end product, CROMSON creates partnerships with the largest manufacturers in North America and Europe.

6

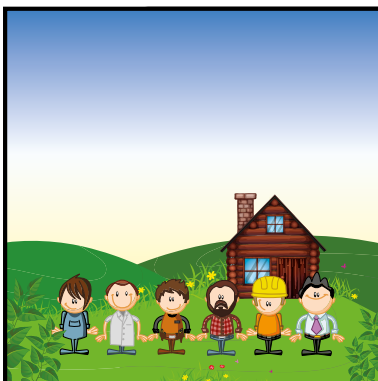

Only 8 years old, this brand benefits from over 200 years of cumulated experience in industrial supply.

7



The brand is in constant evolution and continues to grow because of its partners and collaborators. The CROMSON team stays tuned to new developments in order to always offer the best it possibly can to its clients.

8



online at industrial-supplies.ca

cromson.com



Exclusive distribution:

CROMSON - 1001-465, Saint-Jean,
Montreal, Quebec - H2Y 2R6, CANADA